

Aftermarket products  
& parts catalogue

# 2024

north american  
edition



maelstrom™



aqua-flo™  
by GECKO

Control systems, keypads, pumps,  
accessories, parts & more!



For spa distributors, dealers,  
tech and trade professionals!



## Table of Contents

---

<b>Company Profile</b> .....	4	<b>Spa Cables</b>	
<b>Spa Controls</b>		AMP & Quick Connect .....	18
Y series systems .....	5	<b>Maelstrom pumps</b>	
X series systems .....	8	MS-1 Series .....	19
<b>Spa Keypads</b>		CMS-1.....	21
Y & X series keypads and overlays.....	10	<b>Aqua-Flo Pumps for Spas</b> .....	23
M-CLASS keypads and overlays .....	12	Flo-Master XP3 .....	24
<b>Spa Remote Control Module</b>		Flo-Master XP2e.....	26
in.touch 2 .....	13	Flo-Master XP2 .....	28
<b>Accessories</b>		Flo-Master HP & CP .....	30
in.temp .....	14	Circ-Master HP, CP & XP.....	32
in.lu.me .....	15	<b>Return Procedure</b> .....	34
in.mix 300.....	16	<b>Low Level Configuration</b>	
in.grid .....	16	in.yt .....	35
<b>Waterproof Audio</b>		in.ye.....	36
in.stream 2.....	17	in.yj .....	37
		in.xe.....	38

Gecko®, and their respective logos are Registered Trademarks of Gecko Alliance Group.

All products listed in the catalogue, and their respective logos, are Trademarks of Gecko Alliance Group.

All other product or company names that may be mentioned in this publication are tradenames, trademarks or registered trademarks of their respective owners.

---

## Company Profile

---

### Our products

Our electronic spa controls combine innovation and versatility, and work with a wide range of spas, from the simplest to the most complex. Easy to install, with configuration menus accessible from the keypad — our replacement kits are great value, and are sure to be a must-have in the repair truck.

We also manufacture Maelstrom and Aqua-Flo trademark pumps, known for their energy efficiency and their superior hydraulic capacity. Whether you want to reduce your energy consumption without losing out on power, or to gain power without paying a bundle in energy bills, we have a pump for you.

### Our service

Gecko's technical support team strives to offer the highest level of services. Our team of technicians is there to help your company with any questions you may have on our products, our processes or follow up on an order.

Call us toll free: **1.800.784.3256** from 8 AM to 8 PM ET or email us: **techsupport@geckcoal.com**



Head office, Quebec, Canada



Palmera plant, Tijuana, Mexico



Terra plant, Tijuana, Mexico



## Spa Controls

### Y series



in.yt-7

WxHxD: 19.58" x 14.5" x 5.16" (497 x 368 x 130 mm)

Weight: 12 lb (5.5 kg)

in.ye-5

WxHxD: 19.58" x 10.75" x 4.98" (497 x 273 x 126 mm)

Weight: 9.7 lb (4.4 kg)

in.yj-3

WxHxD: 11.83" x 7.38" x 3.74" (307 x 187 x 95 mm)

Weight: 9 lb (4 kg) with heater



#### Y series

whatever the spa, this is your control system

- Each pack supports keypads, heater, a 12 V light, and configurable relays (3, 5 or 7, depending on model)
- Solid-state water flow detection: No pressure switch to adjust
- IPX5 rated waterproof design
- Preloaded configuration allows fast and easy installation
- Convertible 120/240 V
- Each output voltage can be configured 120/240 V
- Connector: AMP, Quick Connect
- Standard 4 kW, 2" x 15" flow thru heater (minimum of 20GPM required)
- Y & X series keypad compatible
- Temperature probe is built into the heater
- Kinetic heat, overheat & anti-freeze protections
- Self-Diagnostic
- Programmable filter cycles
- Corrosion-free enclosure

See  
Low Level  
Configuration  
on page 35,  
36 & 37.



#### Y series product selector: number of configurable outputs defines supported optional accessories

Features	in.yj-3 (3 outputs)	in.ye-5 (5 outputs)	in.yt-7 (7 outputs)
Model & PN	<b>0612-221041-431</b>	<b>0610-221046-355 (4 kW)</b> <b>0610-221066-363 (5.5 kW)</b>	<b>0611-221031-361</b>
Receptacle type	AMP or Quick Connect	AMP or Quick Connect	AMP or Quick Connect
Optional accessories	Pump 1	Up to 5 outputs of the list. Dual speed pumps use 2 outputs	Up to 7 out of the list. Dual speed pumps use 2 outputs
	Pump 2		
	Pump 3		
	Pump 4		
	Pump 5		
	Blower	Example using 5 outputs: <b>P1-2spd, P2-1spd, Blower and Ozone</b>	Example using 7 outputs: <b>P1 dual speed, P2 dual speed, P3-1spd, Blower and Ozone</b>
	CP		
	Ozone		
Included	Direct outlet	•	•
	Light	12 W @ 12 V AC	12 W @ 12 V AC
	Heater (20 GPM minimum water flow required)	4 kW @ 240 V 1 kW @ 120 V (0613-421009 - remote with cables 4')	4 kW @ 240 V 1 kW @ 120 V
Topside control	in.k120 auxiliary panel	•	•
	in.k200	•	•
	in.k300	•	•
	in.k336	•	•
	in.k19 - in.k35 - in.k8	•	•
	in.k450	•	•
	in.k600 ST 5 OP	•	•
	in.k500 - in.k800 - in.k1000	•	•
	in.touch 2	•	•

### Y series exploded view

Fuses, Y series:

F4 transformer 0.5 A (in.ye-v2 & in.yt only)

**430AC0222**

F1 & F3 Pump, 30 A

**430AC0186**

F2 ACC, 20 A

**430AE0027**

Transformer (in.ye-v2 & in.yt only):  
**560AA0444 (120 V AC)**

Y series packs:

in.ye-5 (4 kW): **0610-221046-355**

in.ye-5 (5.5 kW): **0610-221066-363**

in.yt-7 (4 kW): **0611-221031-361**

Light cable to socket  
**9920-400489 (8' - 2.44 m)**

Light cable & AMP 2 Pins  
**9920-401384 (8' - 2.44 m)**  
**9920-401507 (3" - 7 cm)**

Y series heat.wav heater  
**T9920-101435 (4.0 kW)**  
**9920-101449 (5.5 kW)**

B-EXT-1R (for in.ye-5-v3 only)  
**0610-100005**

### in.yj exploded view

Fuses in.yj:

F2 & F4, pump, 20 A

**430AE0027**

Wall mount bracket in.yj (kit) includes:

in.yj's rectangular mounting plate,  
2 x Tap screw type B,  
#6 x 1/2" Philips pan head, SS

**9920-101490**

Z bracket in.yj  
**9917-106758**

in.yj-3 pack

**0612-221041-431**

in.yj-2 pack heat recovery

**0612-221045-440**

**9920-401397 (Temp. Probe & cable 4' - 1.2 m)**

in.yj heat.wav heater  
**0613-421009**

L bracket in.yj  
**9917-102327**

Light cable to socket  
**9920-400489 (8' - 2.44 m)**

Light cable to AMP 2 Pins  
**9920-401384 (8' - 2.44 m)**  
**9920-401507 (3" - 7 cm)**

LED light bulb: cold white  
**246AA0064**

## Spa Controls

### Complete replacement solution

See  
Low Level  
Configuration  
on page 35,  
36 & 37.



Code	Description
0610-300003	<b>BDLYE5K450: IN.YE-5, IN.K450-30P KEYPAD, CABLES</b> Spa pack: in.ye-5 (0610-221046-355) Keypad: in.k450-30P (0607-005012) Cables: 2 x dual spd AMP cable (95100519), 2 x single spd AMP cable (95100517) & light (9920-400489 - 9920-401507) Adaptor plate (9917-102123)



0610-300006	<b>BDLYE5K830P: IN.YE-5, IN.K8-30P KEYPAD, CABLES</b> Spa pack: in.ye-5 (0610-221046-355) Keypad: in.k8-30P (0607-007067) Cables: 2 x dual spd AMP cable (95100519), 2 x single spd AMP cable (95100517) & light (9920-400489 - 9920-401507) Adaptor plate (9917-102122)
-------------	---



0610-300004	<b>BDLYE5K200: IN.YE-5, IN.K200-20P KEYPAD, CABLES</b> Spa pack: in.ye-5 (0610-221046-355) Keypad: in.k200-20P (0607-008002) Cables: 2 x dual spd AMP cables (95100519), 2 x single spd AMP cable (95100517) & light (9920-400489 - 9920-401507) Adaptor plate (9917-102053)
-------------	---



0612-300001	<b>BDLYJ3K300: IN.YJ-3, IN.K300 KEYPAD, CABLES</b> Spa pack: in.yj-3 (0612-221041-431) Heater: 4kW (0613-421009) Keypad: in.k300-10P (0607-008039) Cables: AMP 2 spd receptacle (9920-401345), QC to QC dual speed (95100251), light (9920-400489 - 9920-401507) & white LED bulb (246AA0064) Mounting acc.: in.k300 adaptor plate (9917-10239), 2 x mounting bracket & screw kit (9920-101490), L bracket (9917-102327)
-------------	---



0612-300002	<b>BDLYJ3K200: IN.YJ-3, IN.K200 KEYPAD, CABLES</b> Spa pack: in.yj-3 (0612-221041-431) Heater: 4kW (0613-421009) Keypad: in.k200-10P (0607-008003) Cables: AMP 2 spd receptacle (9920-401345), QC to QC dual speed (95100251), light (9920-400489 - 9920-401507) & white LED bulb (246AA0064) Mounting acc.: in.k200 adaptor plate (9917-102053), 2 x mounting bracket & screw kit (9920-101490), L bracket (9917-102327)
-------------	--

## Spa Controls

### X series



in.xe

WxHxD: 9.58" x 11.75" x 5.1" (490 x 298 x 136 mm)

Weight: 10.5 lb (4.76 kg)



#### X series

rugged spa pack platform for high-end spas

- IPX5 waterproof rated
- Preloaded configurations allow fast and easy installation
- Large terminal block for easier electrical installation
- Each output voltage supports 120/240 V (in.link)
- Programmable filter cycles
- Solid state dry-fire protection (no pressure switch)
- Kinetic heat, overheat & anti-freeze protections



in.touch 2  
ready!



#### in.xe

- Support up to: 2 pumps, blower, circ pump, ozone & stereo outlet
- 120/240 V convertible (neutral wire always required)
- 2" electrical heater includes temperature sensors and water flow sensor

### X series product selector

Features		in.xe (convertible 120/240V**)	
Order info	Model & PN	0602-221063-299	0602-221066-300
	Receptacle type	in.link	in.link
Pumps	Pump 1	1 or 2 spd	1 or 2 spd
	Pump 2	1 spd***	1 or 2 spd
	Pump 3		
	Pump 4		
	Pump 5		
Accessories	Blower	2 accessories	1 accessory
	CP	2 accessories	1 accessory
	Ozone	2 accessories	1 accessory
	Direct outlet	•	•
	Light (12 W @ 12 V AC)	•	•
Topside control	Heater (20 GPM minimum water flow required)	4 kW @ 240 V 1 kW @ 120 V	4 kW @ 240 V 1 kW @ 120 V
	in.k100 auxiliary panel		•
	in.k120 auxiliary panel	•	
	in.k200	•	•
	in.k300	•	•
	in.k19 - in.k35	•	•
	in.k450 - in.k8	•	•
	in.k600 ST 5 OP	•	•
	in.k600 Graphic		•
	in.k500 - in.k800 - ink1000	•	•
	in.touch 2	•	•

in.link cable is 120 V or 240 V. Make sure to review the cable included when ordering a replacement kit. Allowed Current Draw is 7 A on 4 & 5 pump systems.

\*\* Neutral wire is required to run in 240 V configuration.

\*\*\* Pump 2 cannot be dual speed on PN **0602-221063-299**.

in.xe exploded view

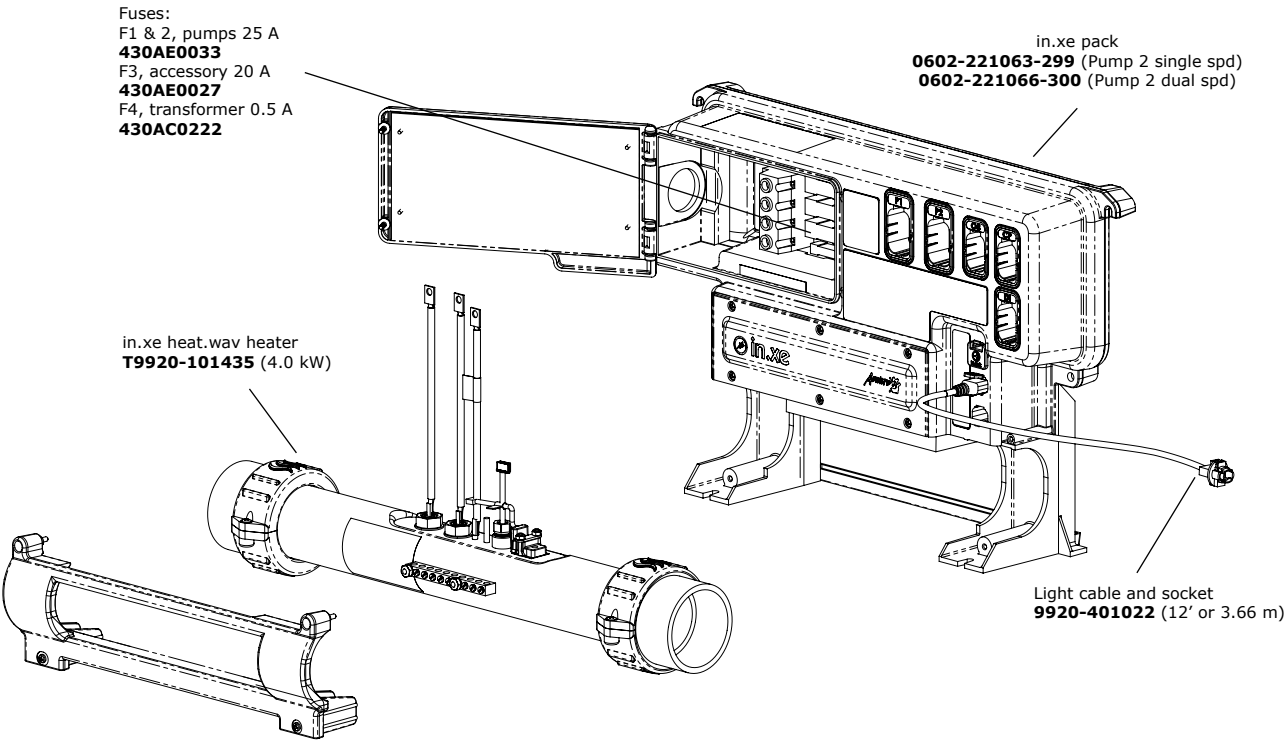

All our techbooks  
and documents here



[geckoalliance.com](http://geckoalliance.com)

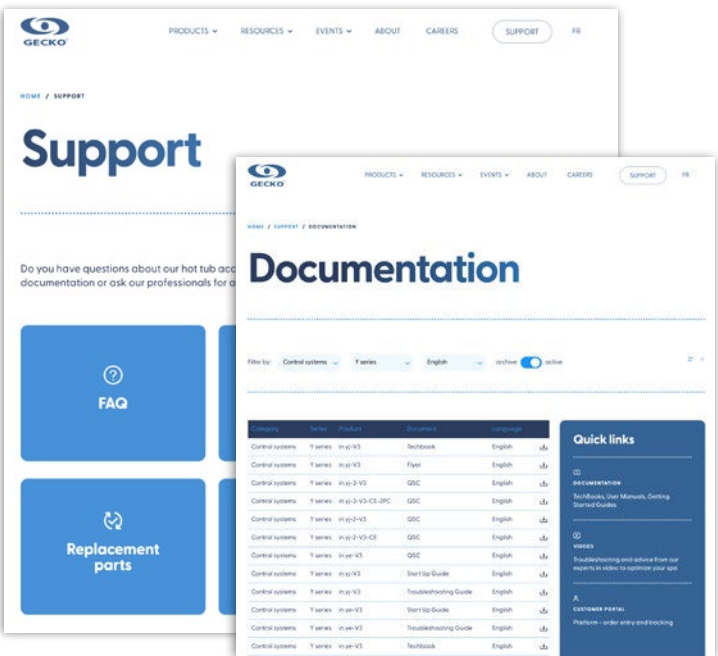

## Spa Key pads

### Y and X series



Code **0607-005033**

#### IN.K1000-BLACK-GE1

Includes: in.k1000 color keypad with touch screen  
 Dimensions: 7-1/2" x 5-1/4" (19 x 13 cm)  
 Cord length: 10' (3 m)  
 Compatible with: in.xe and Y Series systems  
 Installation: MUST be installed on the OUTSIDE edge of the hot tub

Code **0607-008087**

#### IN.K1001-CLEAR-GE1

Includes: in.k1001 color keypad with touch screen  
 Dimensions: 6-3/16" x 3-7/8" (15.4 x 9.8 cm)  
 Cord length: 10' (3 m)  
 Compatible with: in.xe and Y Series systems  
 Installation: MUST be installed on the OUTSIDE edge of the hot tub

Code **0607-008030**

#### IN.K806-CLEAR AND OVERLAY GE1

Includes: in.k800 color keypad and overlay (**9916-101480**)  
 10 buttons: Settings/Mode/P1/P2/P3/AUX1/AUX2/Light/Up/Down  
 Dimensions: 8-3/4" x 4-1/4" (22.2 x 10.8 cm)  
 Cord length: 10' (3 m)  
 Compatible with: Y and X Series systems  
 Installation: MUST be installed on the OUTSIDE edge of the hot tub

Code **0607-008033**

#### IN.K506-CLEAR AND OVERLAY GE1

Includes: in.k500 color keypad and overlay (**9916-101495**)  
 7 buttons: Settings/Light/Mode/Pump 1/Pump 2/Up/Down  
 Dimensions: 7-1/8" x 3-3/8" (18.2 x 8.5 cm)  
 Cord length: 10' (3 m)  
 Compatible with: Y and X Series systems  
 Installation: MUST be installed on the OUTSIDE edge of the hot tub.

Code **0607-008112**

#### IN.K336 AND OVERLAYS

Includes: in.k336 color keypad and overlays  
 Overlay 10P (**9916-101749**) 5 buttons: Up/Down/Pump 1/Light/Program  
 Overlay 20P (**9916-101750**) 5 buttons: Up/Down/Pump 1/Pump 2/Light  
 Dimensions: 7 1/8" x 3 1/10" (18.2 x 7.6 cm)  
 Cord length: 10' (3 m)  
 Compatible with: Y Series systems

## Spa Keypads

### Y and X series



Code **0607-008064**

#### IN.K600-5OP AND OVERLAY (BDLK6005OP)

Includes: in.k600 keypad with streamlined interface, overlay (**9916-101382**)  
 11 buttons: Light/Pump 1 to 5/OK/+/-/Prog/Power  
 Dimensions: 8-3/4" x 4-1/4" (22.2 x 10.8 cm)  
 Cord length: 10' (3 m)  
 Compatible with: in.xe, in.xm, in.xm2 & Y Series systems



Code **0607-005012** **0607-005017** (25' - 7,62 m cable)

#### IN.K450-3OP AND OVERLAY (BDLK4503OP)

Includes: in.k450 keypad, overlay (**9916-101335**)  
 7 buttons: On/Pump 1/Pump 2/Pump 3/Light/Up/Down  
 Dimensions: 7-1/4" x 3" (18.1 x 7.6 cm)  
 Cord length: 10' - 3 m (**0607-005012**), 25' - 7,62 cm (**0607-005017**)  
 Compatible with: in.xe, in.xm, in.xm2 & Y Series system



Code **0607-007067**

#### IN.K8-3OP AND OVERLAY (BDLK83OP)

Includes: in.k8-3OP keypad, overlay (**9916-101675**)  
 8 buttons: Pump 1/Pump 2/Pump 3-Blower/Light/ Power/Prog/Up/Down  
 Dimensions: 7" x 3-1/4" (17.8 x 8.25 cm)  
 Cord length: 10' (3 m)  
 Compatible with: in.xe & Y Series systems

Note: Replaces in.k19 & in.k35 (same shape, different keys)



Code **0607-008039** (1 pump) **0608-008040** (2 pumps)

#### IN.K300 AND OVERLAY (BDLK3001OP - BDLK3002OP)

Includes: in.k300-1OP keypad, overlay (**9916-101499**)  
 4 buttons: Pump 1/Light/Up/Down  
 or  
 Includes: in.k300-2OP keypad, overlay (**9916-101500**)  
 4 buttons: Pump 1/Pump 2/Light/Up-Down

Dimensions: 6-1/4" x 2-1/4" (15.9 x 7.5 cm)  
 Cord length: 10' (3 m)  
 Compatible with: Y Series systems



Code **0607-008003** (1 pump) **0607-008002** (2 pumps)

#### IN.K200 AND OVERLAY (BDLK2001OP - BDLK2002OP)

Includes: in.k200-1OP keypad, overlay (**9916-101203**)  
 4 buttons: Pump 1/Light/Up/Down  
 or  
 Includes: in.k200-2OP keypad, overlay (**9916-101030**)  
 4 buttons: Pump 1/Pump 2/Light/Up-Down

Dimensions: 4-3/4" x 2" (12 x 5.1 cm)  
 Cord length: 10' (3 m)  
 Compatible with: in.xe & Y Series systems

## Spa Key pads

### Y and X series



Code **0607-005019**

#### IN.K120-30P AND OVERLAY

Includes: in.k120 auxiliary keypad and overlay  
4 buttons: Pump 1/Pump 2/Pump 3/Light  
Dimensions: 3-1/2" x 2-1/8" (9 x 5.4 cm)  
Cord length: 20' (6 m)  
Compatible with: in.xe, in.xm, in.xm2 & Y Series systems

## M-CLASS



Code **0201-007044**

#### TSC-4-10K-GE1 AND OVERLAY (BDLTSC410K)

Includes: TSC-4-10K keypad, overlay (9916-100761)  
10 buttons: Pump 3/Pump 1/Pump 2/Blower/Light/Clock/Economy/Filter/Up/Down  
Dimensions: 7" x 3-1/4" (17.8 x 8.25 cm)  
Cord length: 10' (3 m)  
Compatible with: M-CLASS systems



Code **0200-007119**

#### TSC-4-GE1 AND OVERLAY (BDLTSC4GE1)

Includes: TSC-4 keypad, overlay (9916-100094)  
8 buttons: Up/Pump 1/Pump 2/Prog/Down/Blower/Light/Mode  
Dimensions: 7" x 3-1/4" (17.8 x 8.25 cm)  
Cord length: 10' (3 m)  
Compatible with: M-CLASS systems



Code **0201-007153**

#### TSC-8-10K-GE1 AND OVERLAY (BDLTSC810K)

Includes: TSC-8-10K keypad, overlay (9916-100723)  
10 buttons: Power/Pump 1/Pump 2/Light/Up/Economy/Pump 3/Blower/Filter/Down  
Dimensions: 7" x 3-1/4" (17.8 x 8.25 cm)  
Cord length: 10' (3 m)  
Compatible with: M-CLASS systems



Code **0200-007194**

#### TSC-8-PPD AND OVERLAY (BDLTSC8GE1)

Includes: TSC-8 keypad, overlay (9916-100130 and 9916-100331)  
8 buttons: Pump 1/Pump 2/Blower/Light/Power/Filter/Up/Down  
Dimensions: 7" x 3-1/4" (17.8 x 8.25 cm)  
Cord length: 10' (3 m)  
Compatible with: M-CLASS systems

## Spa Remote Control Module

### in.touch 2



#### in.touch 2

ultimate mobile remote control for your spa

- Push notifications to alert consumers even when the app is not open
- Extended communication range: 3 times longer than standard Wi-Fi signal
- Simple plug & play network through your ethernet connection
- Intuitive app layout
- Control pumps, blower and light
- Control water temperature set point
- Water care settings to save energy
- Retail ready packaging

Compatible spa controllers: X and Y series versions 2012 and later

Compatible devices: For iOS and Android smartphones and tablets



Find the in.touch 2 app  
on App Store or Google Play

Works with Amazon Alexa and Google Home.



\* iPad, iPhone and Android phones not included.

### in.touch 2 complete solution:

Code	Description
0608-521020	<b>IN.TOUCH 2: RF INTERFACE MODULE FOR SPA</b> Control your hot tub from your iDevice: iPad, iPhone, iPod and Android devices The module connects to your home network to provide remote control of your spa. Kit includes: 2 communication modules (Spa unit (7' or 2 m cable) & network unit), ethernet cable (3' or 0.9 m), Wallmount power adaptor and wire (3' or 0.9 m) Compatible with: in.xm2, in.xe and Y Series



Remote supervision  
of your spa and hot tub installed base.

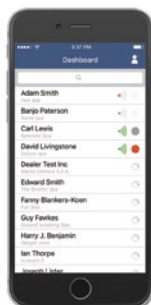

Dealer dashboard.

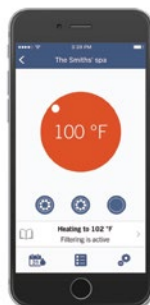

Customer spa pages.

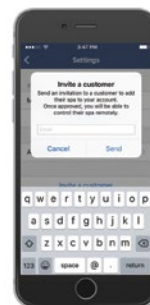

Permission request.

More than a new pro app, a smarter way to work!

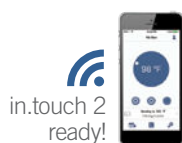
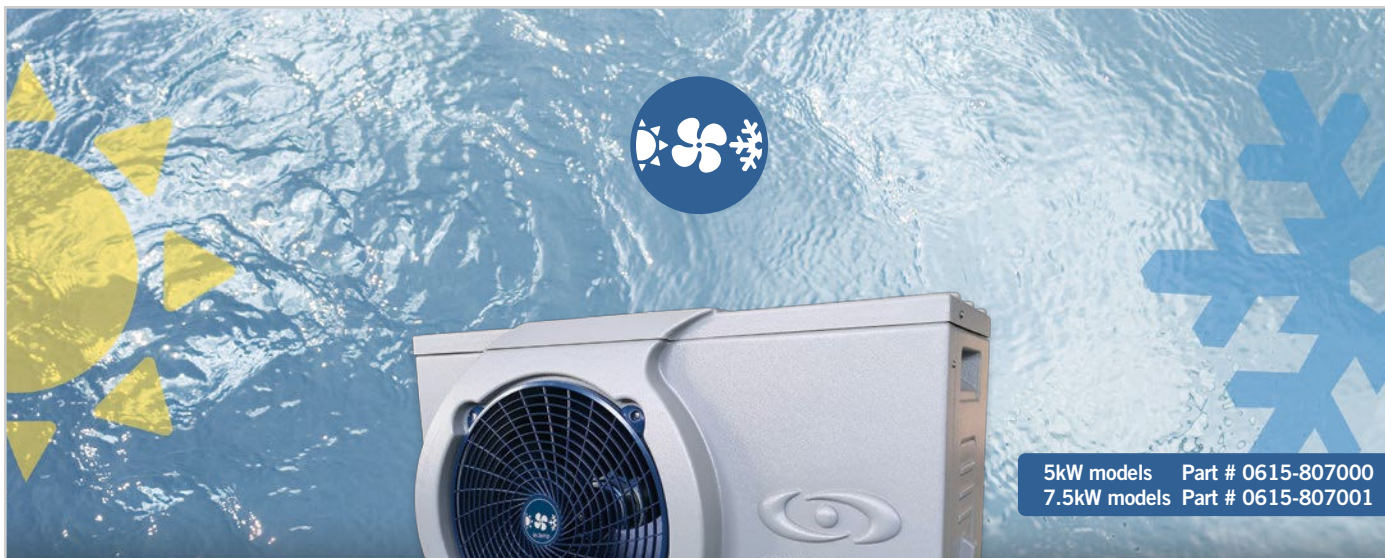

## in.temp

A new way to regulate the water of your spa.

World-class, quiet and efficient.

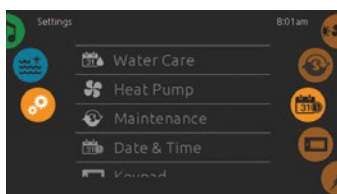

### Plug and play solution

Here comes Gecko's new heat pump solution. Using our in.temp has never been so easy! Simply connect it to a Y series control that supports it and you're good to go! Automatic detection, smart power management and no additional power circuit required, the in.temp powers directly from the spa control.

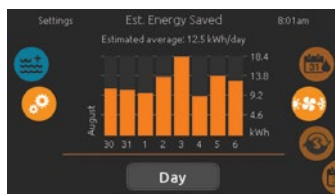

### Benefit from energy savings

Are you looking for the most energy efficient form of heating water? Our in.temp is the perfect solution! Air sourced heat pumps, will allow you to save up to 75% energy consumption in comparison with electric elements. The icing on the cake: Gecko's in.temp also uses an eco-friendly refrigerant (R32 and R410A).

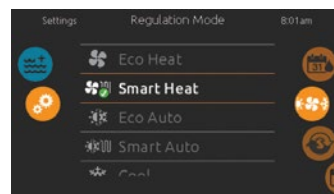

### Total flexibility that can also cool down water

With in.temp, you can choose one of its six modes of operation that suits you the best: Eco Heat, Smart Heat, Eco Auto, Smart Auto, Cool and Electric! No matter the weather, your spa will always be at the perfect temperature. Smart modes let you taking full advantage of your in.temp to optimize your savings.

### compatibility

Wide selection of keypads (auto-detected by the system upon power up)



in.k330  
color LCD display, 5 keys



in.k500  
color LCD display, 7 keys



in.k800  
color LCD display, 10 keys



in.k1001+  
color LCD capacitive  
touchscreen display



in.k1000+  
color LCD capacitive  
touchscreen display

Learn more about in.temp at [www.geckointemp.com](http://www.geckointemp.com)

## Accessories

### in.lu.me



in.lu.me  
most comprehensive LED system for spas and hot tubs

- System of loop, spyder and cluster cables with high-intensity RGB LED lights
- Made for in.mix 300 color lighting console
- Sturdy water resistant connections (IPX5)
- Quick, easy and clean installation
- Bigger wire gage on loop
- More LEDs on your spa
- Compatible with: in.k1000, in.k800 and in.touch 2



### in.lu.me installation

#### Configuration example: 120 LEDs

- ① 1 in.lu.me-loop-1 & 1 in.lu.me-clus-9
- ② 1 in.lu.me-loop-8 & 7 in.lu.me-spyd-6 & 1 in.lu.me-clus-9
- ③ 1 in.lu.me-loop-4 & 4 in.lu.me-spyd-6
- ④ 1 in.lu.me-loop-8 & 2 in.lu.me-spyd-6 & 6 in.lu.me-spyd-4

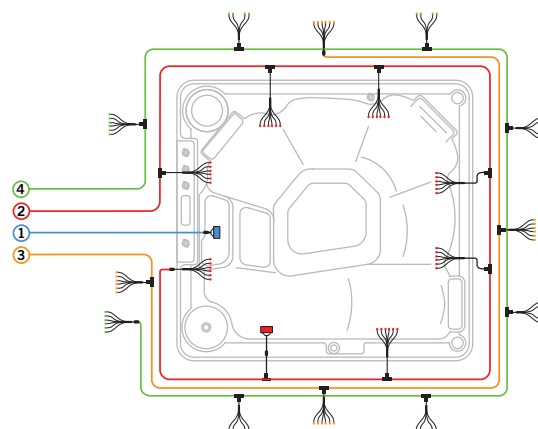

#### Code

#### Description



0699-500016

#### IN.LU.ME-SPYD-4 V2

Spyder cable 4 LEDs  
Cord length: 60" (1.5 m)



0699-500017

#### IN.LU.ME-SPYD-6 V2

Spyder cable 6 LEDs  
Cord length: 60" (1.5 m)



0699-500018

#### IN.LU.ME-LOOP-8-L V2

Loop cable with 8 t-shaped connectors at every 1.2 m (48")  
Cord length: 408" (10 m)



0699-500019

#### IN.LU.ME-LOOP-4-L V2

Loop cable with 4 t-shaped connectors at every 2.4 m (96")  
Cord length: 360" (9 m)



0699-500020

#### IN.LU.ME-CLUS-9 V2

Main light, 9 LED cluster



0699-500021

#### IN.LU.ME-EXT-5 V2

Cable adaptor 5' from loop to cluster  
Cord length: 60" (1.5 m)



0699-500022

#### IN.LU.ME-LOOP-1-8 V2

Loop cable with 1 connector  
Cord length: 8' (2.4 m)

## Accessories

### in.mix 300



#### in.mix 300

create stunning underwater color shows with our light system

- A lighting control console at your fingertips
- Lights up to 3 different color zones in, or around your spa
- Built-in power supply
- Up to 100 points of RGB, LED light sold separately
- Additional CO connector
- Compatible with: in.k1000, in.k800 and in.touch 2
- Dimensions (WxHxD): 7.03" x 6.13" x 2.22" (179 x 156 x 56 mm)
- Weight: 1.9 lb (870 g)



Code	Description
------	-------------

0609-521009	<b>IN.MIX-300: IN.MIX-300-LU.ME-AMP-GE1</b> Compatible with in.lu.me LED system
0609-521001	<b>IN.MIX-300: AMP POWER CORD, MOLEX 5VDC LED PORT</b> Compatible harness cable (1 per lighting zone): 9920-401478
0609-521003	<b>IN.MIX-300: AMP POWER CORD, MTA 12VDC LED PORT</b> Compatible harness cable (1 per lighting zone): 9920-401479
0609-521005	<b>IN.MIX-300: IN.LINK POWER CORD, JJ 5VDC LED PORT</b> Compatible with J&J Electronics, inc. Color Choice LED System



#### in.grid

a flexible way to control your external heating source

- Perfect for selecting, using and synchronizing alternative heat sources
- 4 single switches and one CO connector for your accessories
- Energy saving
- The choice between 4 modes of operation:
  - Internal: electrical heater only
  - External: secondary heat source only
  - Both: electrical heater & secondary heat source
  - Smart: secondary heat source & electrical heater if needed
- Compatible with: Y series specific software required
- Dimensions (WxHxD): 5.50" x 4.48" x 1.84" (140 x 114 x 47 mm)

Code	Description
------	-------------

0608-521033	<b>IN.GRID: 4 SWITCH + CO + HEAT PUMP CONTROL</b> The in.grid provides a connection to a normally open dry-contact relay through a spring-loaded female connector. Therefore an external heat source can be controlled by the in.grid. Relay is rated 24V, 4A. External heat source must be made compatible with this remote switching method.
0607-007010	<b>IN.K110 SINGLE SWITCH (BDLK110)</b> 1 button: control pump from each seat Dimensions: 1-½" (3.8 cm) diameter Cord length: 20' (6 m) Compatible with: in.grid (0608-521033)
9916-100480	<b>OVERLAY FOR IN.K110 (BDLK110)</b>



Waterproof Audio

in.stream 2







WxHxD: 9.81" x 2.58" x 8.88" (249 x 66 x 225 mm)  
Weight: 3.6 lb (1.6 kg)



in.stream 2  
streamed from your spa, your favorite music never sounded so good!







Features

- Powerful and efficient class D amplifiers
  - Up to 4 speaker outputs (200W at 4 Ohms)
  - 1 subwoofer output (100W at 2 Ohms)
- Supported audio sources
  - Bluetooth streaming
  - Aux in
  - USB stick
  - FM radio
- Smartphone charger through USB connector
- Wall mount installation
- Built-in universal power supply
- Robust, fully splash proof (IPx5) enclosure

Code	Description
	<b>0704-121007 IN.STREAM 2 PRO AUDIO SYSTEM, POWER SUPPLY - IN.LINK CORD</b> in.stream 2 spa audio system with in.link cable: built-in power supply (100-240VAC) Up to 4 speaker outputs, 1 subwoofer output. Sources in stand-alone mode: Bluetooth, Auxiliary input Sources if connected to a Gecko Pack with Color keypads: Bluetooth, Auxiliary input, USB, FM radio Compatible with X series systems
	<b>0704-121008 IN.STREAM 2 PRO AUDIO SYSTEM, POWER SUPPLY - QUICK CONNECT CORD</b> in.stream 2 spa audio system with Quick Connect cable: built-in power supply (100-240VAC) Up to 4 speaker outputs, 1 subwoofer output. Sources in stand-alone mode: Bluetooth, Auxiliary input Sources if connected to a Gecko Pack with Color keypads: Bluetooth, Auxiliary input, USB, FM radio Compatible with Y series systems and any control that support Quick Connect tabs
	<b>9920-401425 CABLE: ADAPTOR IN.STREAM 1 OR IN.CHANT TO IN.STREAM 2</b>
	<b>0707-005015 IN.K175 KEYPAD FOR IN.STREAM 2 AUDIO SYSTEM</b> 7 buttons: Power/Bluetooth/AUX/Volume Up - Down/Previous Track/Next Track Dimensions: 3.58" x 2.15" (9 x 5.5 cm) Cord length: 20' (6 m) Compatible with: in.stream 2 audio system

## Spa Cables

### AMP & Quick Connect

	Code	Description
	95100517	CABLE: AMP-4P TO QC, SINGLE SPEED 14/3, 4' (1.2 M)
	95100519	CABLE: AMP-4P TO QC, DUAL SPEED 14/4, 4' (1.2 M)
	9920-401316	COMMUNICATION CABLE FOR IN.XE & IN.YE SWIM SPA SOLUTION, 8' (2.5 M) <small>Cable Length: 8' (2.5 m)</small>
	9920-401345	RECEPTACLE CABLE OUTPUT AMP 2 SPEED, 14AWG, LENGTH 8" (20 CM)
	9920-401346	CABLE 1 SPD, AMP TO QUICK CONNECT, 14AWG, LENGTH 8" (20 CM)
	9920-401369	CABLE SPLITTER PP-1 AMP MALE TO 2 FEMALE, LENGTH 6" (15 CM)



Available on Aqua-Flo by Gecko pumps for spas and hot tubs!  
with features that speak for themselves and benefits that are all yours!

- Less parts for an optimized reliability (5 parts compared to 7 for other seals)
- Superior leak resistance (through less interpret joints than other seals)
- Twice as much sealing surface on impeller shaft than other seals for optimal torque transmission
- Full rubber protection through stainless steel 316 jacket
- Low friction ceramic (silicon ceramic)
- Crimped carbon friction ring for maximized strength



going strongly against the flow  
pumps for small to swim spas



## Maelstrom Pumps for Spas

### MS-1 series



**maelstrom™**

the spa pump standard has been raised

- Longer life capacitor with high temp. 185°F
- Sealed bearing
- Low energy in low speed
- Seal: Gecko high quality Universeal
- 2" intake and discharge
- Tail piece (2)
- Three wing nut drain plugs
- 96" cable with AMP plug
- Strong packaging solution: Dual-layered cardbox with molded foam for safe storage and transportation

Universeal  
inside!



#### Dimension and Performance Curves Maelstrom MS-1

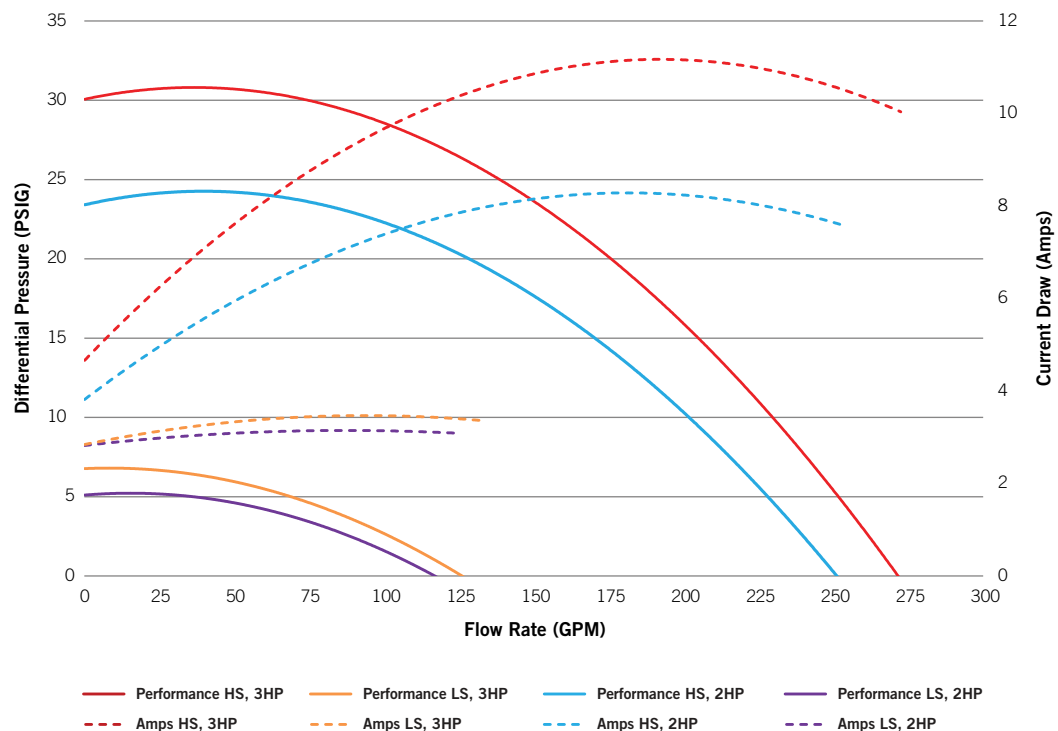
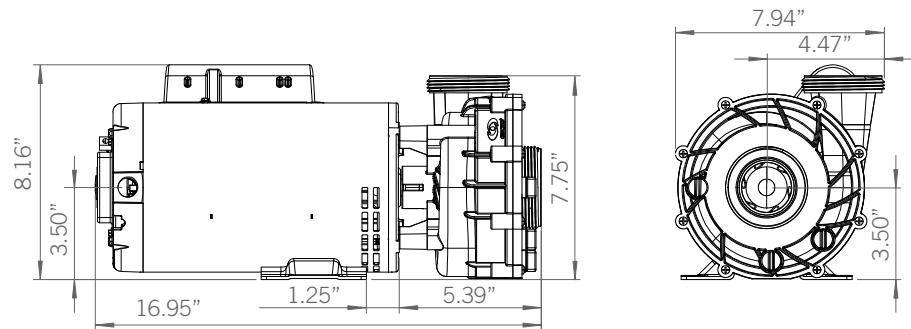

Maelstrom Pumps for Spas

MS-1 series

Maelstrom MS-1 exploded view

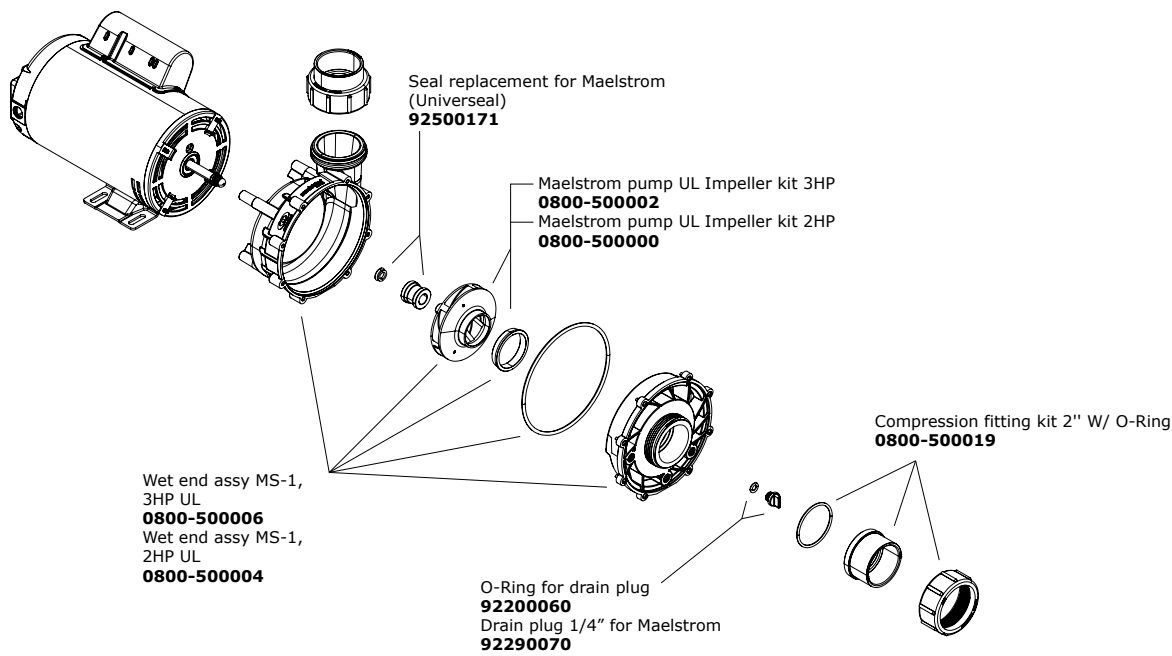

Maelstrom MS-1 series

Dual-speed, 2" intake & discharge

Part No.	hp in	hp out	Input Rating	Frame Size	Speed	A	HMAX (ft)	QMAX (GPM)
0800-390000	3.5	3.0	230V 60Hz	56	High	12	72	271
					Low	3.5	17	132
0800-390005	2.6	2.0	230V 60Hz	56	High	8.4	57	254
					Low	3.2	13	124

## Maelstrom Pumps for Spas

### CMS-1



**maelstrom™**

the spa pump standard has been raised

- Longer life capacitor with high temp. 85°C
- Sealed bearing
- 1,5" to 2" adaptor available
- Seal: Gecko high quality Universeal
- 1,5" intake and discharge
- Tail piece (2)
- Three wing nut drain plugs
- 96" cable with AMP plug
- Strong packaging solution: Dual-layered cardbox with molded foam for safe storage and transportation

Universeal  
inside!



#### Dimension and Performance Curves Maelstrom CMS-1

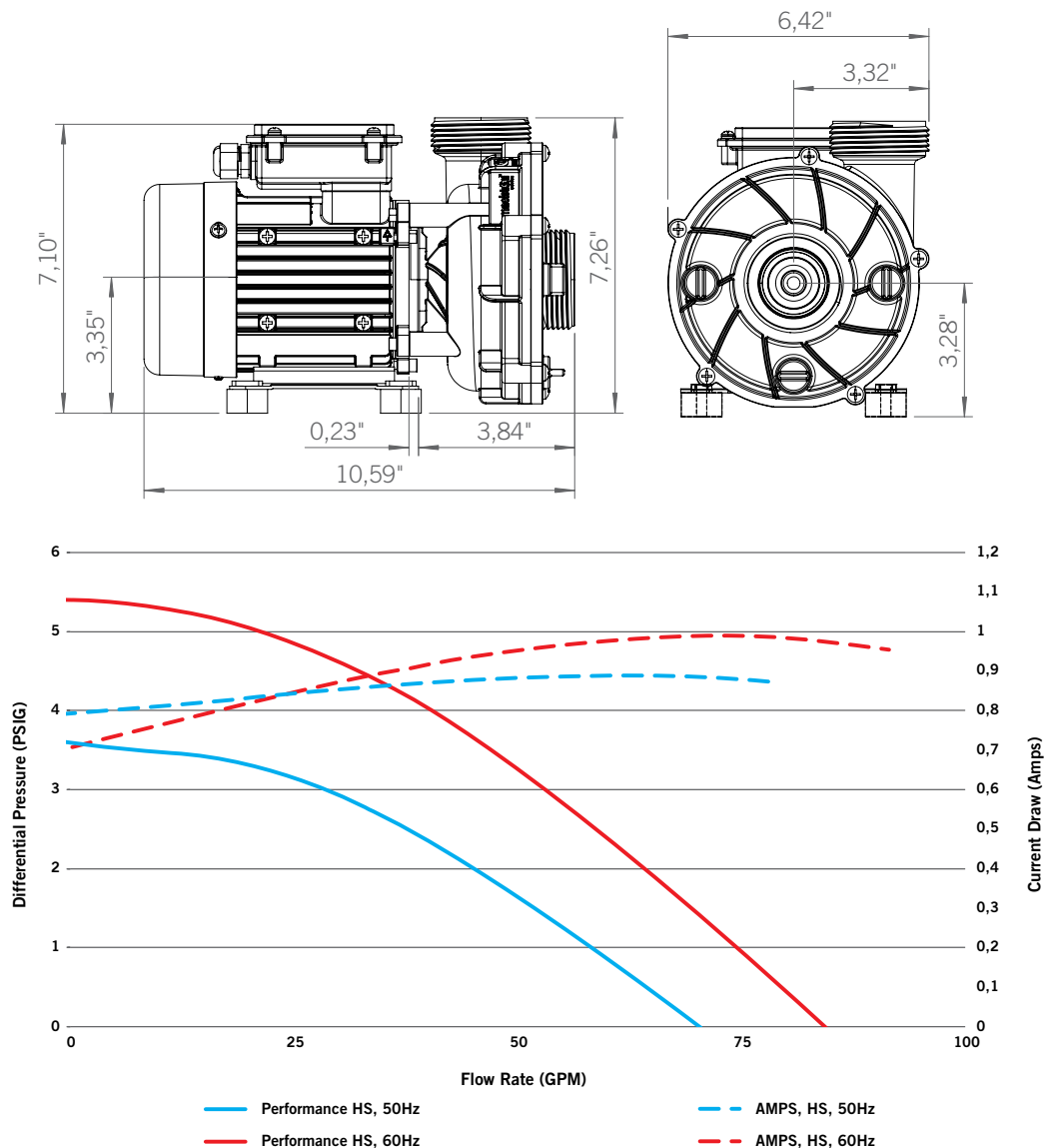

Maelstrom Pumps for Spas

CMS-1 series

Maelstrom CMS-1 exploded view

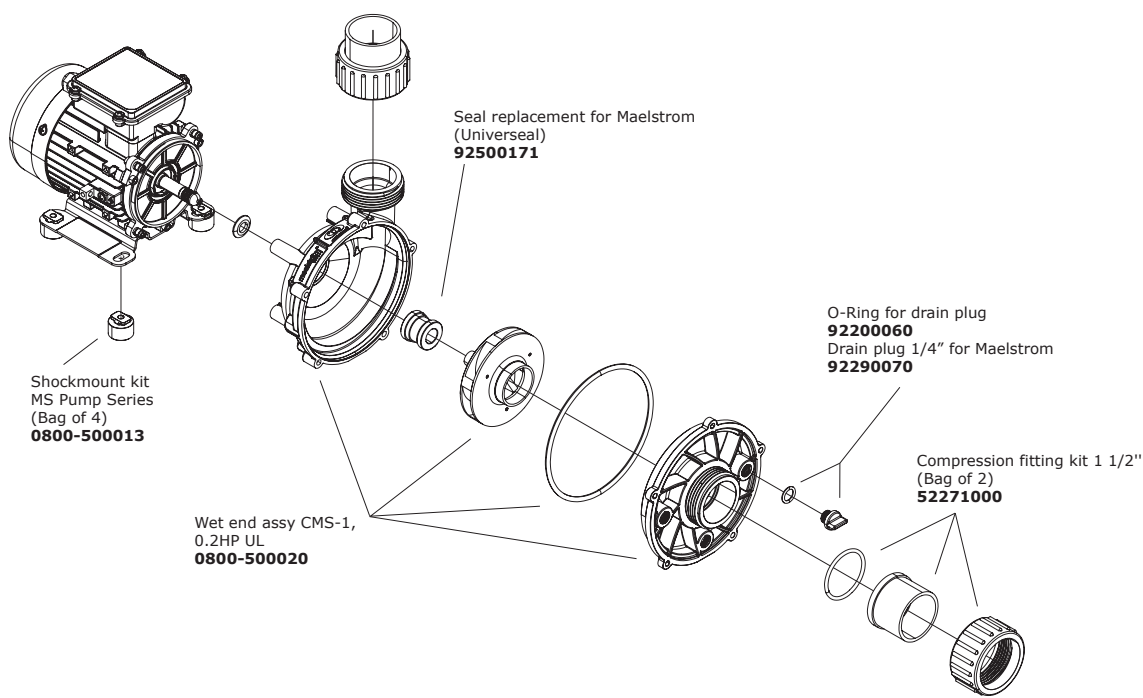

Maelstrom CMS-1 series

Dual-speed, 1.5" intake & discharge

Part No.	hp out	Input Rating	Frame Size	Speed	A	HMAX (ft)	QMAX (GPM)
0800-690000	0.2	220-240V 60Hz	56	One	1	12,5 ft / 3,81 m	85 GPM / 320 LPM

## Aqua-Flo Pumps for Spas

**OP.HP** stands for operational horse power and is a notation specific to Aqua-flo. If you replace an Aqua-flo pump, make sure the OP.HP rating matches the hp rating on the old pump. If you are replacing another pump brand by one below, refer to the hp rating in the tables.

### Flo-Master XP3 Series, 60Hz, 56 Frame



- Booster jet pumps
- 2 ½" intake & discharge
- Flow rate 200-310 GPM
- 56 frame motor

#### Dual-speed, 2 ½" intake & discharge

Part No.	hp	Volts	A (High)	A (Low)	OP.HP	Hi-Flo GPM
08326000-2041	3.0	230	10.9	3.2	2.5	200
08330002-5041	4.0	230	11.9	4.1	3.0	250
08342761-2041	5.0	230	15.0	4.6	4.0	325

### Flo-Master XP2e Series, 60Hz, 56 Frame



- Booster jet pumps
- 2" intake & discharge
- Flow rate 170-260 GPM
- 56 frame motor

#### Dual-speed, 2" intake & discharge

Part No.	hp	Volts	A (High)	A (Low)	OP.HP	Hi-Flo GPM
05320761-2040	3.0	230	8.9	4.7	2.0	170
05340009-5040	5.0	230	14.0	4.5	4.0	260

#### Dual-speed, 2 ½" intake & 2.0" discharge

Part No.	hp	Volts	A (High)	A (Low)	OP.HP	Hi-Flo GPM
05320762-5040	3.0	230	8.9	4.7	2.0	170
05340011-5040	5.0	230	14.0	4.5	4.0	260

### Flo-Master XP2 Series, 60Hz, 48 Frame



- Booster jet pumps
- 2" intake & discharge
- Dual-speed
- Flow rate 125-180 GPM
- 48 frame motor

#### Dual-speed, 2" intake & discharge

Part No.	hp	Volts	A (High)	A (Low)	OP.HP	Hi-Flo GPM
06610006-2040	1.5	115	10.5	3.2	1.0	115
06115000-1040	2.0	115	12.8	3.9	1.5	125
06115517-2040	2.0	230	7.3	2.0	1.5	125
06120500-2040	3.0	230	8.5	2.6	2.0	150
06125000-1040	4.0	230	9.5	3.0	2.5	180

### Flo-Master Series, 60Hz, 48 Frame



- Booster jet pumps
- 1 ½" intake & discharge
- Dual-speed
- Flow rate 60-130 GPM
- 48 frame motor

#### Center discharge, dual-speed, 1 ½" intake & discharge

Part No.	hp	Volts	A (High)	A (Low)	OP.HP	Hi-Flow GPM
02610000-1010	1.5	115	9.0	3.2	1.0	80
02615000-1010	2.0	115	13.3	3.9	1.5	100
02615005-1010	2.0	230	7.5	2.0	1.5	100

#### Side discharge, dual-speed, 1 ½" intake & discharge

Part No.	hp	Volts	A (High)	A (Low)	OP.HP	Hi-Flow GPM
02107000-1010	1.0	115	8.2	3.0	0.75	65
02110000-1010	1.5	115	9.0	3.2	1.0	85
02115000-1010	2.0	115	13.3	3.9	1.5	105
02115005-1010	2.0	230	n/a	n/a	1.5	105
02120000-1010	3.0	230	9.7	6.6	2.0	130

### Circ-Master Series



- Ideal 24/7 circ pump apps.
- Intake & discharge
  - CMHP & CP: 1 ½"
  - CMXP: 2"
- Single-speed pump
- Flow rate 25-45 GPM
- 48 frame motor

#### Center discharge, single-speed, 1 ½" intake & discharge

Part No.	hp	Volts	A	OP.HP	Flow (GPM)
02593000-2010	1/8	115	1.2	1/15	40
02593001-2010	1/8	230	0.65	1/15	40

#### Side discharge, single-speed, 1 ½" intake & discharge

Part No.	hp	Volts	A	OP.HP	Flow (GPM)
02093000-2010	1/8	115	1.2	1/15	40
02093001-2010	1/8	230	0.65	1/15	40

#### Side discharge, single-speed, 2" intake & discharge

Part No.	hp	Volts	A	OP.HP	Flow (GPM)
06093000-2000	1/8	230	0.7	1/12	50

Every pump comes with 2 compression fittings & without cord. Except for CMXP that come with a 5 ft (1.5 m) 18/3 AMP-4P cord.

## Aqua-Flo Pumps for Spas

### Flo-Master XP3



**XP3**

Flo-Master XP3  
the power behind the performance of your spa

- Booster jet pumps
- Ideal for swim spas and high-flow requirements
- Dual-speed
- Flow rate up to 350 GPM
- 56 frame motor
- 2.5" intake and discharge
- Seal: Viton



#### Dimension and Performance Curves XP3

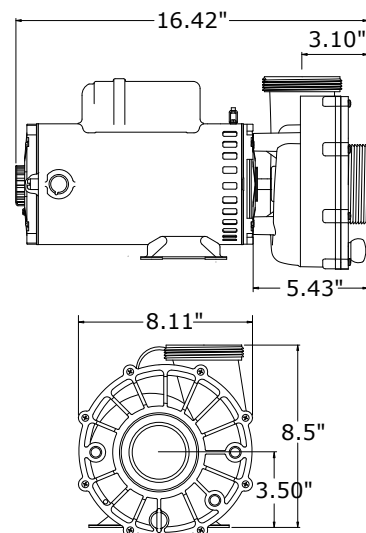
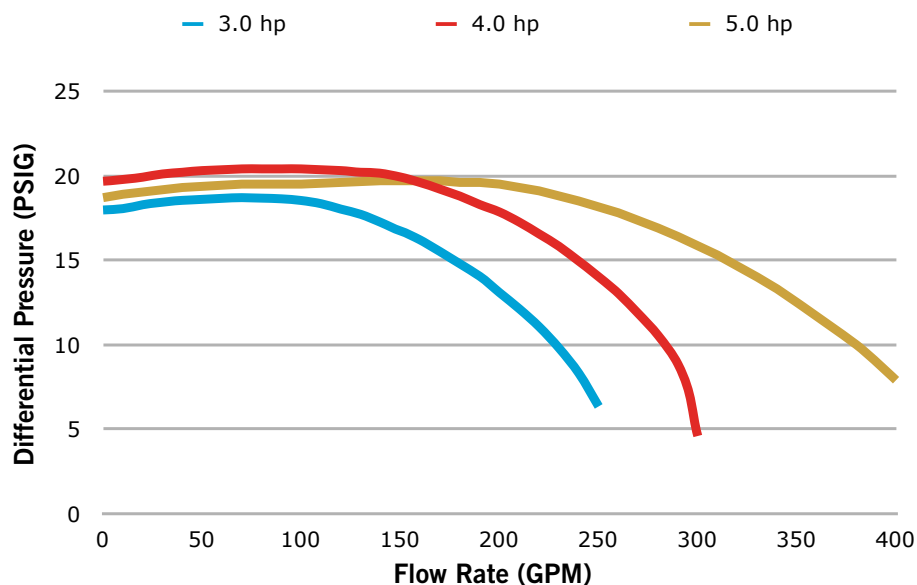

#### Flo-Master XP3 Series, 60Hz, 56 Frame

Dual-speed, 2 1/2" intake & discharge

Part No.	hp	Volts	A (High)	A (Low)	OP.HP*	Hi-Flow GPM
08326000-2041	3.0	230	10.9	3.2	2.5	200
08330002-5041	4.0	230	11.9	4.1	3.0	250
08342761-2041	5.0	230	15.0	4.6	4.0	325

Every pump comes with 2 compression fittings & without cord.

\* OP.HP refers to operational duty horsepower.

# Aqua-Flo Pumps for Spas

## Flo-Master XP3

Flo-Master XP3 exploded view

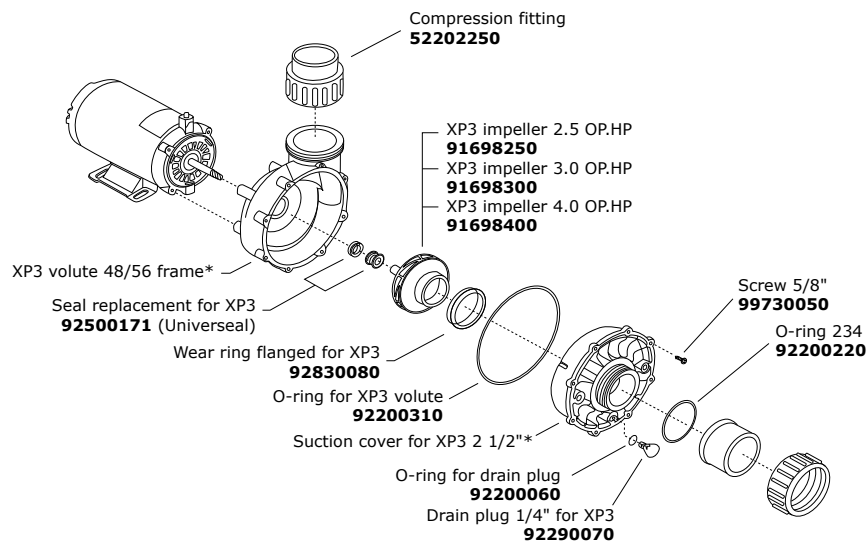

\* Covers and volutes not available separately. A complete wet end replacement is required.

### Flo-Master XP3 Wet Ends 48FR/56FR, 2 ½" intake & 2 ½" side discharge

	Part No.	OP.HP**
	91042125-000	2.5
	91042130-000	3.0
	91042140-000	4.0

\*\* OP.HP refers to operational duty horsepower.

Aqua-Flo Pumps for Spas

Flo-Master XP2e



Flo-Master XP2e  
greater flow-rates with overall energy efficiency

- Booster jet pumps
- Ideal for multi-jet applications
- Dual-speed
- Flow rate up to 280 GPM
- 56 frame motor
- 2" intake and discharge
- Seal: Viton



Dimension and Performance Curves FM-XP2e

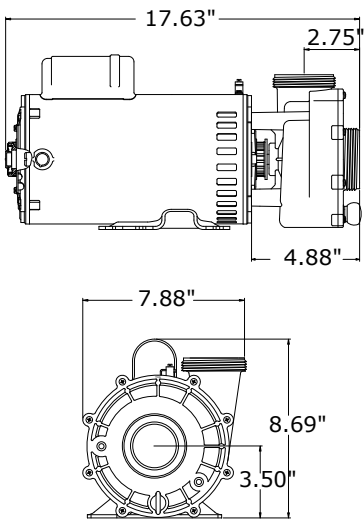
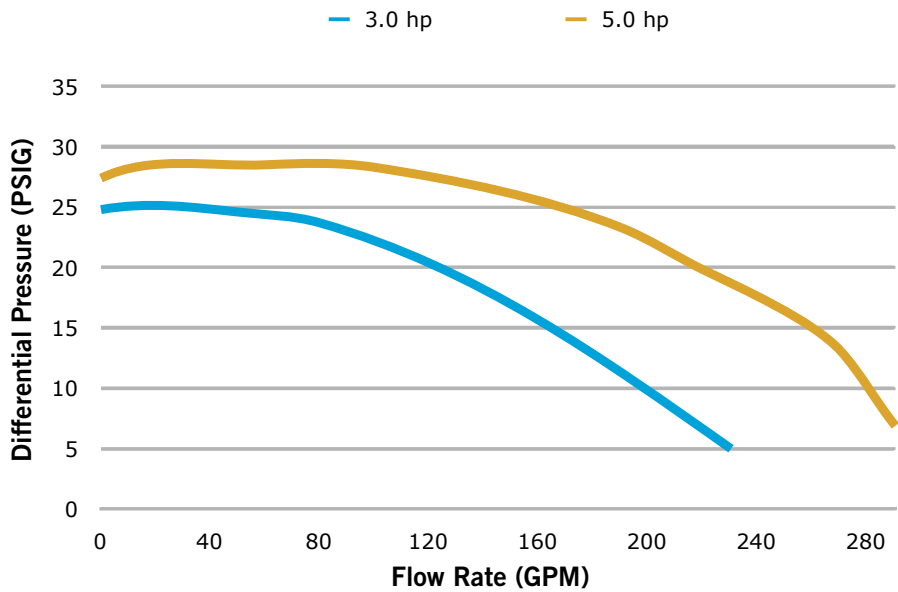

Flo-Master XP2e Series, 60Hz, 56 Frame

Dual-speed, 2" intake & discharge

Part No.	hp	Volts	A (High)	A (Low)	OP.HP*	Hi-Flow GPM
05320761-2040	3.0	230	8.9	4.7	2.0	170
05340009-5040	5.0	230	14.0	4.5	4.0	260

Dual-speed, 2.5" intake & 2" discharge

Part No.	hp	Volts	A (High)	A (Low)	OP.HP*	Hi-Flow GPM
05320762-5040	3.0	230	8.9	4.7	2.0	170
05340011-5040	5.0	230	14.0	4.5	4.0	260

Every pump comes with 2 compression fittings & without cord.

\* OP.HP refers to operational duty horsepower.

## Aqua-Flo Pumps for Spas

### Flo-Master XP2e

#### Flo-Master XP2e exploded view

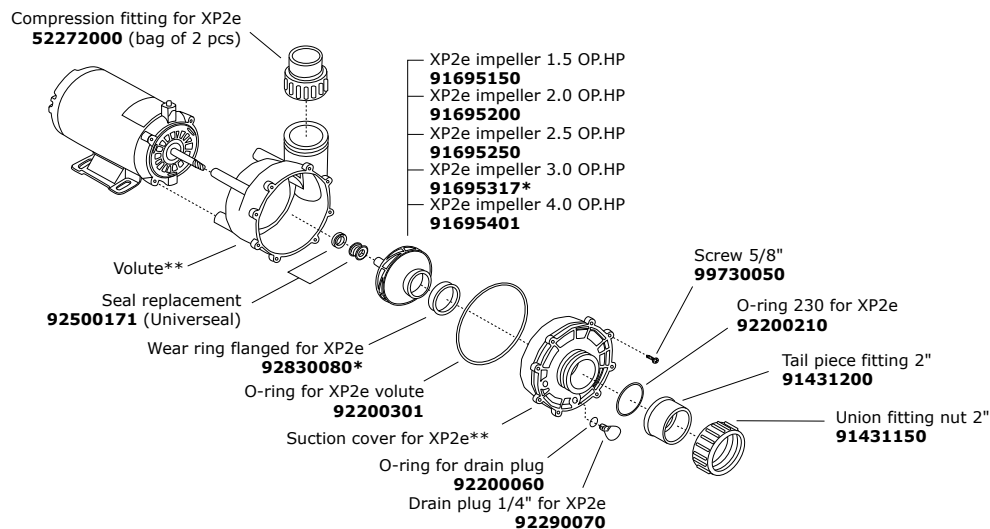

\* 3.0 OP.HP impeller **91695317** needs a specific Wear ring **92830081**

\*\* Covers and volutes not available separately. A complete wet end replacement is required.

#### Flo-Master XP2e Wet Ends 48FR, 2" intake & side discharge

	Part No.	OP.HP***
	91041608-000	1.0
	91041815-000	1.5
	91041820-000	2.0
	91041825-000	2.5
	91041830-000	3.0
	91041613-000	4.0

#### Flo-Master XP2e Wet Ends 56FR, 2" intake & side discharge

	Part No.	OP.HP***
	91041915-000	1.5
	91041920-000	2.0
	91041925-000	2.5
	91041930-000	3.0
	91041940-000	4.0

#### Flo-Master XP2e Wet Ends 56FR, 2.5" intake & 2" side discharge

	Part No.	OP.HP***
	91041922-060	2.0
	91041932-060	3.0
	91041942-060	4.0

\*\*\* OP.HP refers to operational duty horsepower.

## Aqua-Flo Pumps for Spas

### Flo-Master XP2



**XP2**

Flo-Master XP2  
high performance pump

- Booster jet pumps
- Dual-speed
- Flow rate up to 225 GPM
- 48 frame motor
- 2" intake and discharge
- Seal: Viton



#### Dimension and Performance Curves XP2

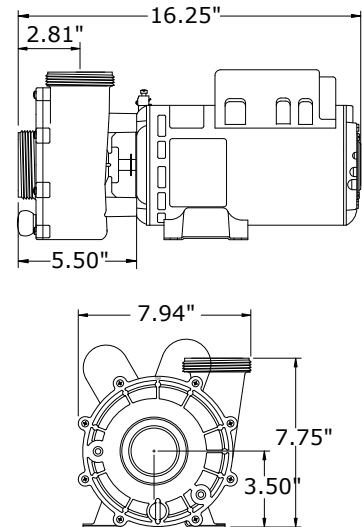
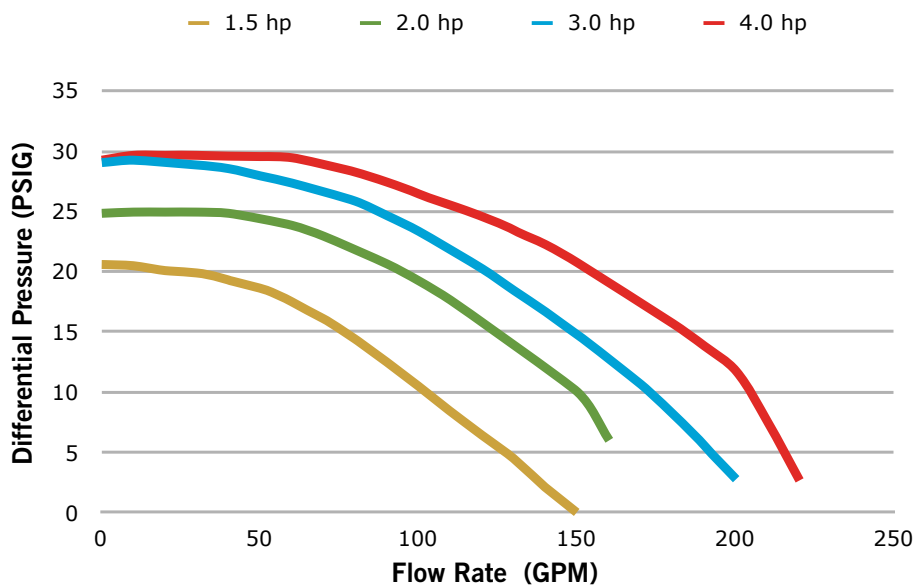

#### Flo-Master XP2 Series, 60Hz, 48 frame

##### Dual-speed, 2" intake & discharge

Part No.	hp	Volts	A (High)	A (Low)	OP.HP*	Hi-Flow GPM
06610006-2040	1.5	115	10.5	3.2	1.0	115
06115000-1040	2.0	115	12.8	3.9	1.5	125
06115517-2040	2.0	230	7.3	2.0	1.5	125
06120500-2040	3.0	230	8.5	2.6	2.0	150
06125000-1040	4.0	230	9.5	3.0	2.5	180

Every pump comes with 2 compression fittings & without cord.

\* OP.HP refers to operational duty horsepower.

## Aqua-Flo Pumps for Spas

### Flo-Master XP2

#### Flo-Master XP2 exploded view

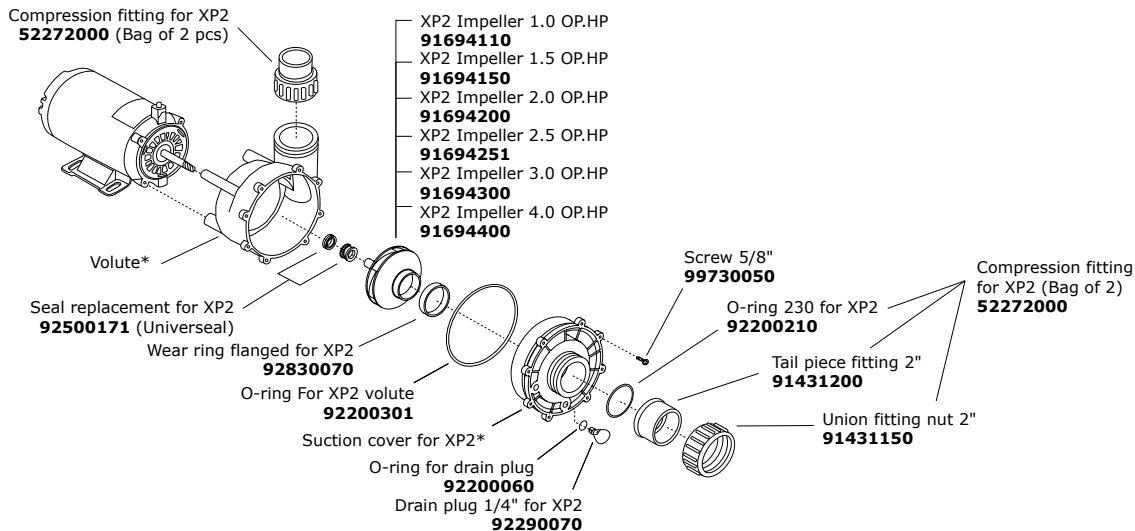

\* Covers and volutes not available separately. A complete wet end replacement is required.

#### Flo-Master XP2 Wet Ends 48FR, 2" intake & side discharge



Part No.	OP.HP**
<b>91041608-000</b>	1.0
<b>91041815-000</b>	1.5
<b>91041820-000</b>	2.0
<b>91041825-000</b>	2.5
<b>91041830-000</b>	3.0
<b>91041613-000</b>	4.0

#### Flo-Master XP2 Wet Ends 56FR, 2" intake & side discharge



Part No.	OP.HP**
<b>91041915-000</b>	1.5
<b>91041920-000</b>	2.0
<b>91041925-000</b>	2.5
<b>91041930-000</b>	3.0
<b>91041940-000</b>	4.0

#### Flo-Master XP2 Wet Ends 56FR, 2.5" intake & 2" side discharge



Part No.	OP.HP**
<b>91041922-060</b>	2.0
<b>91041932-060</b>	3.0
<b>91041942-060</b>	4.0

\*\* OP.HP refers to operational duty horsepower.

## Aqua-Flo Pumps for Spas

### Flo-Master HP & CP



Flo-Master HP & CP  
high performance pumps for portable spas and hot tubs

- Booster jet pumps
- Dual-speed
- Flow rate up to 130 GPM
- 48 frame motor
- 1 1/2" intake and discharge
- Wet end available in center or side discharge configuration
- Seal: Viton



Dimension and Performance Curves Flo-Master HP & CP

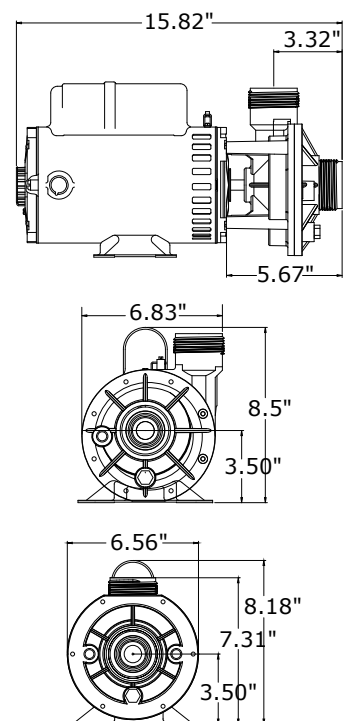
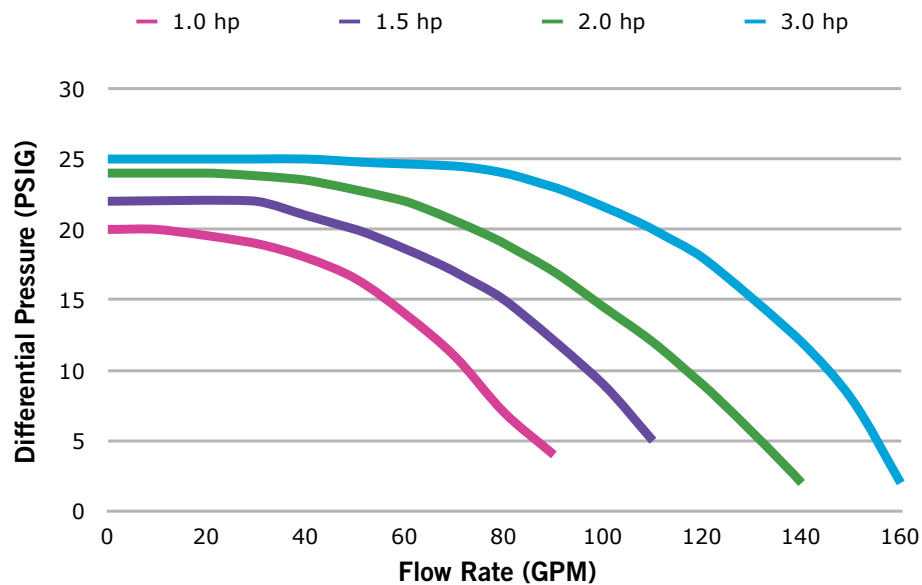

#### Flo-Master Series, 60Hz, 48 Frame

##### Center discharge, Dual-speed, 1 1/2" intake & discharge

Part No.	hp	Volts	A (High)	A (Low)	OP.HP*	Hi-Flow GPM
02610000-1010	1.5	115	9.0	3.2	1.0	80
02615000-1010	2.0	115	13.3	3.9	1.5	100
02615005-1010	2.0	230	7.5	2.0	1.5	100

##### Side discharge, Dual-speed, 1 1/2" intake & discharge

Part No.	hp	Volts	A (High)	A (Low)	OP.HP*	Hi-Flow GPM
02107000-1010	1.0	115	8.2	3.0	0.75	60
02110000-1010	1.5	115	9.0	3.2	1.0	85
02115000-1010	2.0	115	13.3	3.9	1.5	105
02115005-1010	2.0	230	n/a	n/a	1.5	105
02120000-1010	3.0	230	9.7	3.2	2.0	130

Every pump comes with 2 compression fittings & without cord.

\* OP.HP refers to operational duty horsepower.

Flo-Master HP & CP

Flo-Master HP & CP exploded view

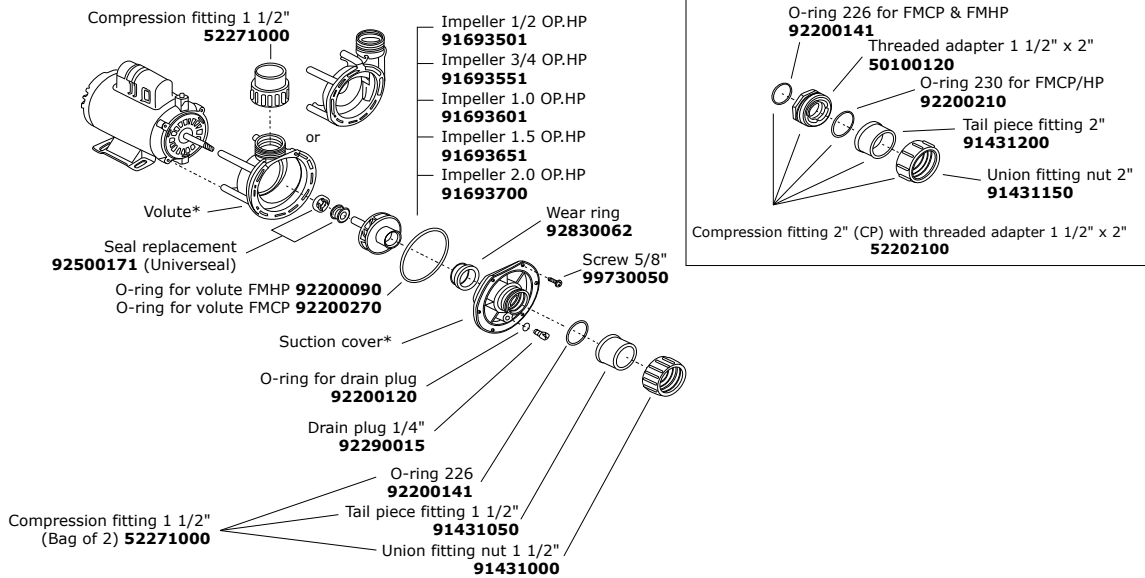

\* Covers and volutes not available separately. A complete wet end replacement is required.

Flo-Master Wet Ends 48FR, 1 1/2" intake & discharge

	Part No.	OP,HP**	Discharge
	91040830-000	0.5	Center
	91040800-000	0.75	Center
	91040810-000	1.0	Center
	91040820-000	1.5	Center
	91040840-000	2.0	Center
	91040680-000	0.5	Side
	91040690-000	0.75	Side
	91040700-000	1.0	Side
	91040720-000	1.5	Side
	91040730-000	2.0	Side

\*\* OP,HP refers to operational duty horsepower.

## Aqua-Flo Pumps for Spas

### Circ-Master HP, CP & XP



CM

Circ-Master HP, CP & XP  
24-hour recirculation pumps

- Ideal for 24/7 circ pump applications
- Single speed
- Flow rate up to 50 GPM
- Intake and discharge
  - CMHP & CP: 1 1/2"
  - CMXP: 2"
- Wet end available in center or side discharge configuration
- Seal: Universeal

Universeal  
inside!



#### Dimension and Performance Curves Circ-Master

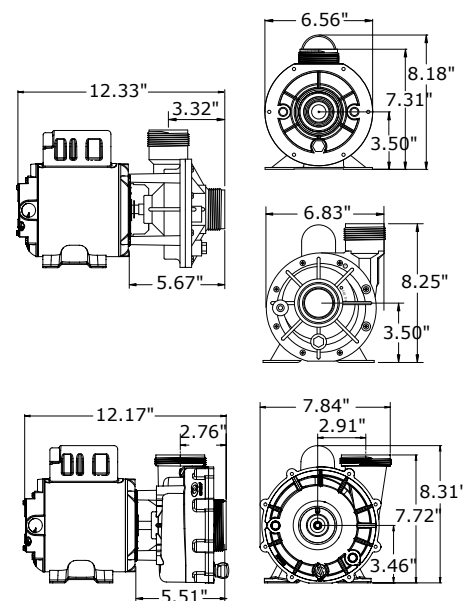
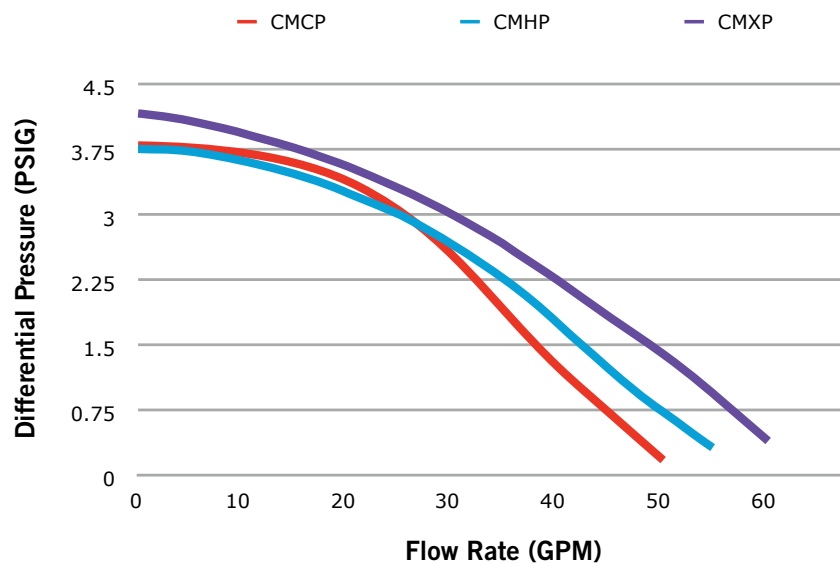

#### Circ-Master CP

Center discharge, single-speed, 1 1/2" intake & discharge

Part No.	hp	Volts	A	OP.HP*	Hi-Flow GPM
02593000-2010	1/8	115	1.2	1/15	35
02593001-2010	1/8	230	0.65	1/15	35

#### Circ-Master HP

Side discharge, single-speed, 1 1/2" intake & discharge

Part No.	hp	Volts	A	OP.HP*	Hi-Flow GPM
02093000-2010	1/8	115	1.2	1/15	40
02093001-2010	1/8	230	0.65	1/15	40

#### Circ-Master XP

Side discharge, single-speed, 2" intake & discharge

Part No.	hp	Volts	A	OP.HP*	Hi-Flow GPM
06093000-2000	1/8	230	0.7	1/12	50

Every pump comes with 2 compression fittings & without cord. Except for CMXP that come with a 5 ft 18/3 AMP-4P cord.

\* OP.HP refers to operational duty horsepower.



# Aqua-Flo Pumps for Spas

## Circ-Master HP, CP & XP

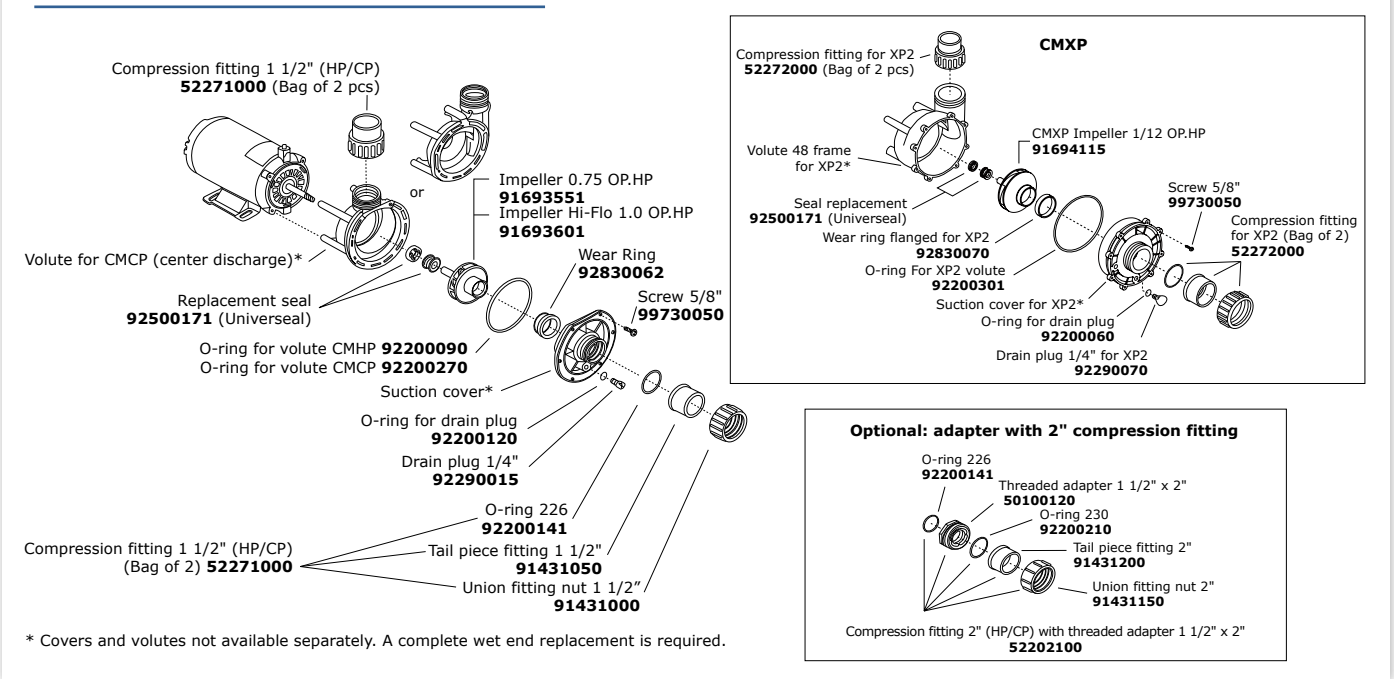
Circ-Master HP, CP & XP exploded view



### Circ-Master HP & CP Wet Ends 48FR, 1 1/2" intake & discharge

	Part No.	OP.HP**	Discharge
	91040800-000	1/15	Center
	91040690-000	1/15	Side

### Circ-Master XP Wet Ends 48FR, 2" intake & discharge

	Part No.	OP.HP**	Discharge
	91041608-000	1/12	Side

\*\* OP.HP refers to operational duty horsepower.

## Return Procedure

---

Need to return merchandise? Please follow our return procedure:

- 1 Complete the Return Form and e-mail it back to Gecko Alliance to **warranty@geckcoal.com**
- 2 Upon reception of the Return Form, Gecko Alliance will issue a Returned Merchandise Authorization Number (RMA#) and will e-mail it back to you.
- 3 Please note that:
  - you must write the RMA# on all boxes addressed and returned to Gecko Alliance. Any merchandise returned without an RMA# will be sent back to its sender.
  - you must carefully pack the returned merchandise or you will be held responsible for any damage incurred during transportation.
- 4 Send the merchandise to Gecko Alliance, freight prepaid. Please keep the waybill numbers of your shipment(s) in case the merchandise is lost and tracking is necessary.
- 5 Returned merchandise will be tested within a maximum of 2 weeks after receipt. If the cause of the problem is not covered by Gecko's warranty, the repair will be invoiced to you (see Warranty Statement).
- 6 Repaired merchandise will be returned. Products that cannot be repaired will be replaced by the same, or an equivalent, product. A service invoice is issued and mailed with each report.

**Canadian customers:**

Gecko Alliance Repair Center  
450 des Canetons  
Quebec QC G2E 5W6  
Canada

For more assistance, call Gecko's Technical Support Department at **1.800.78.GECKO** or by email at **techsupport@geckcoal.com**

## Low Level Configuration

in.yt

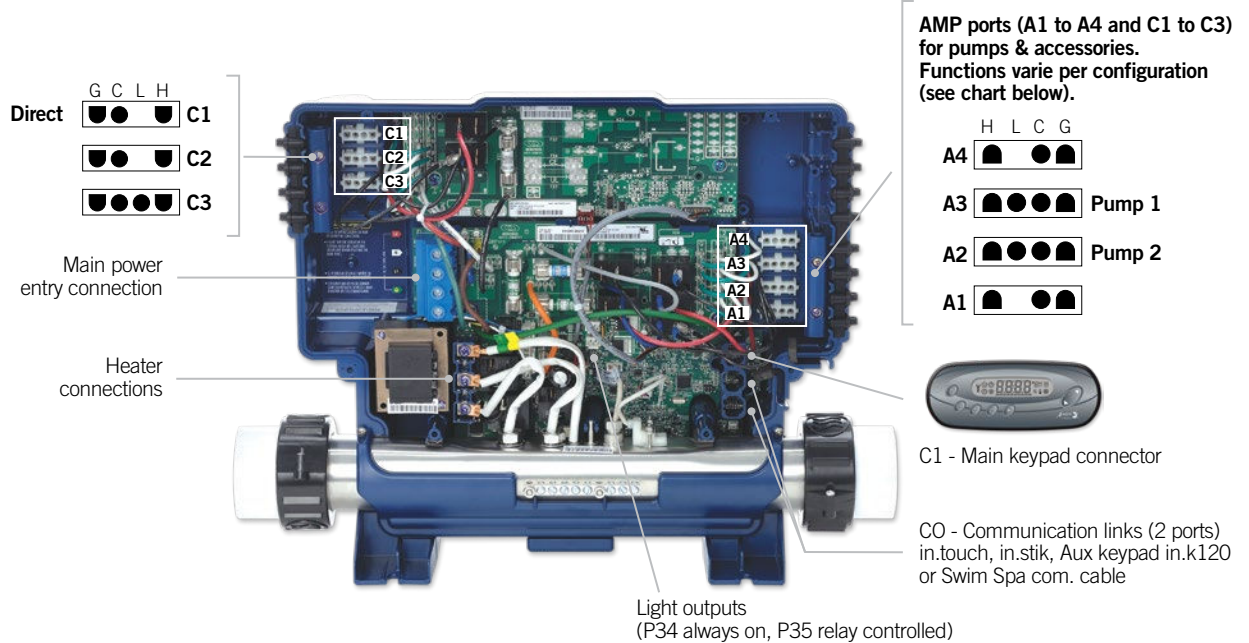

### Preloaded spa configurations, ID # 0611-221031-361, Software # 361 rev 4.0

Information between ( ) indicates which AMP connector to use. See above drawing for connector's position.

Config. #	Pump 1	Pump 2	Pump 3	Pump 4	Pump 5	Blower	Circ. Pump (CP)	Ozone <sup>1</sup>	120 V Light	Filter Cycle (Daily)	Heater Pump
1	1sp (A3)	1sp (A2)	1sp (C3)				(C2)	(A1)		2 x 6 hours with CP	CP
2	1sp (A3)	1sp (A2)	1sp (C3)			(A4)	(C2)	(A1)		2 x 6 hours with CP	CP
3	1sp (A3)	1sp (A2)	1sp (C3)	1sp (A4)			(C2)	(A1)		2 x 6 hours with CP	CP
4	1sp (A3)	1sp (A2)	1sp (C3)	1sp (A4)		(A1)	(C2)	(K2-P tab) <sup>2</sup>		2 x 6 hours with CP	CP
5	1sp (A3)	1sp (A2)	1sp (C3)	1sp (A4)	1sp (A1)		(C2)	(K2-P tab) <sup>2</sup>		2 x 6 hours with CP	CP
6	1sp (A3)	1sp (A2)	1sp (C3)	1sp (A4)	1sp (A1)	(K2-P tab) <sup>2</sup>	(C2)			2 x 6 hours with CP	CP
7	2sp (A3)	1sp (A2)	1sp (C3)					(A1)		2 x 2 hours with P1L	Pump 1
8	2sp (A3)	1sp (A2)	1sp (C3)			(A4)		(A1)		2 x 2 hours with P1L	Pump 1
9	2sp (A3)	1sp (A2)	1sp (C3)				(C2)	(A1)		2 x 6 hours with CP	CP
10	2sp (A3)	1sp (A2)	1sp (C3)			(A4)	(C2)	(A1)		2 x 6 hours with CP	CP
11	2sp (A3)	1sp (A2)	1sp (C3)	1sp (A4)				(A1)		2 x 2 hours with P1L	Pump 1
12	2sp (A3)	1sp (A2)	1sp (C3)	1sp (A4)		(C2)		(A1)		2 x 2 hours with P1L	Pump 1
13	2sp (A3)	1sp (A2)	1sp (C3)	1sp (A4)			(C2)	(A1)		2 x 6 hours with CP	CP
14	2sp (A3)	1sp (A2)	1sp (C3)	1sp (A4)		(A1)	(C2)			2 x 6 hours with CP	CP
15	2sp (A3)	1sp (A2)	1sp (C3)	1sp (A4)	1sp (A1)			(C2)		2 x 2 hours with P1L	Pump 1
16	2sp (A3)	1sp (A2)	1sp (C3)	1sp (A4)	1sp (A1)	(C2)				2 x 2 hours with P1L	Pump 1
17	2sp (A3)	1sp (A2)	1sp (C3)	1sp (A4)	1sp (A1)		(C2)			2 x 6 hours with CP	CP
18	2sp (A3)	2sp (A2)	1sp (C3)					(A1)		2 x 2 hours with P1L	Pump 1
19	2sp (A3)	2sp (A2)	1sp (C3)			(C2)		(A1)		2 x 2 hours with P1L	Pump 1
20	2sp (A3)	2sp (A2)	1sp (C3)				(C2)	(A1)		2 x 6 hours with CP	CP
21	2sp (A3)	2sp (A2)	1sp (C3)			(A1)	(C2)			2 x 6 hours with CP	CP
22	2sp (A3)	2sp (A2)	2sp (C3)					(A1)		2 x 2 hours with P1L	Pump 1
23	2sp (A3)	2sp (A2)	2sp (C3)			(A1)				2 x 2 hours with P1L	Pump 1
24	2sp (A3)	2sp (A2)	2sp (C3)				(A1)			2 x 6 hours with CP	CP
25	2sp (A3)	1sp (A2)						(A1)	(A4)	2 x 2 hours with P1L	Pump 1
26	2sp (A3)	1sp (A2)				(C3)		(A1)	(A4)	2 x 2 hours with P1L	Pump 1
27	2sp (A3)	1sp (A2)					(C2)	(A1)	(A4)	2 x 6 hours with CP	CP
28	2sp (A3)	1sp (A2)				(C3)	(C2)	(A1)	(A4)	2 x 6 hours with CP	CP
29	2sp (A3)	2sp (A2)						(A1)	(C2)	2 x 2 hours with P1L	Pump 1
30	2sp (A3)	2sp (A2)				(C3)		(A1)	(C2)	2 x 2 hours with P1L	Pump 1

**Note 1:** When the Ozonator is not controlled by a relay, it can be tied to Pump 1 Low speed or Circ. Pump using AMP cable 9920-401369.

**Note 2:** This accessory does not have its own AMP connector. Wire an extra AMP connector 9920-401346 (not supplied) as follows: Black wire to P43 tab on the board, Green to any G tabs and white to any N tabs for 120 V accessory or any L2 tabs for 240 V.

## Low Level Configuration

in.ye

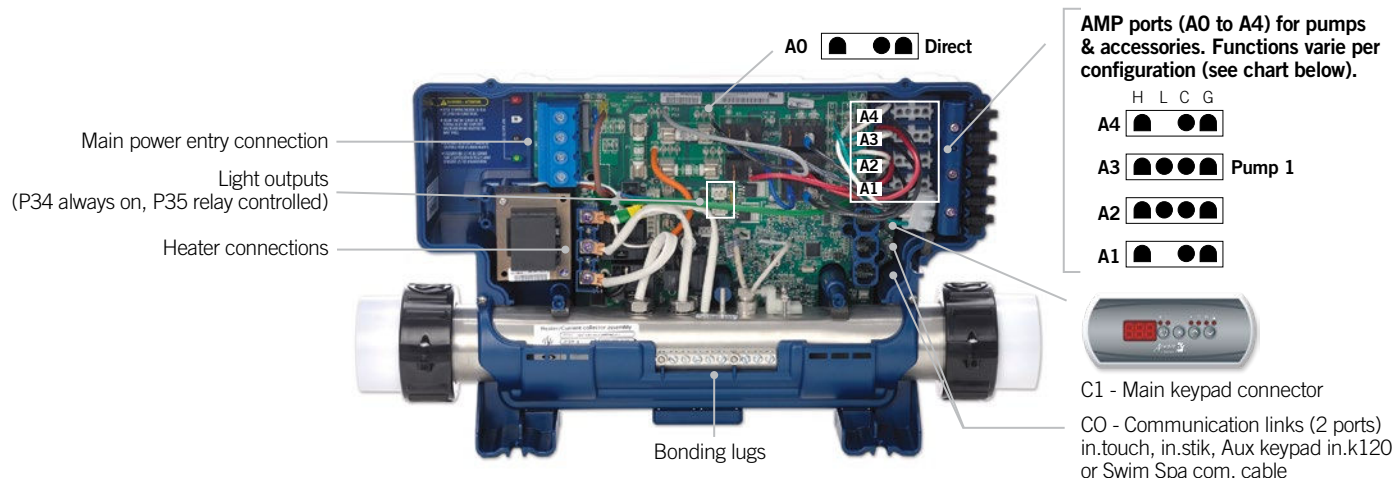

### Preloaded spa configurations, ID # 0610-221046-355, Software # 355 rev 4.0

Information between ( ) indicates which AMP connector to use. See above drawing for connector's position.

Config. #	Pump 1	Pump 2	Pump 3	Pump 4	Pump 5	Blower	Circ. Pump (CP)	Ozone <sup>1</sup>	Filter Cycle (Daily)	Heater Pump
1	2 sp (A3)							(A1)	2 x 2 hours with P1L	Pump 1
2	2 sp (A3)						(A1)	(A4)	2 x 6 hours with CP	CP
3	2 sp (A3)	1 sp (A2)						(A1)	2 x 2 hours with P1L	Pump 1
4	2 sp (A3)	1 sp (A2)					(A1)	(A4)	2 x 6 hours with CP	CP
5	2 sp (A3)					(A4)		(A1)	2 x 2 hours with P1L	Pump 1
6	2 sp (A3)					(A4)	(A1)	(A2)	2 x 6 hours with CP	CP
7 <sup>4</sup>	2 sp (A3)	1 sp (A2)				(A4)		(A1)	2 x 2 hours with P1L	Pump 1
8	2 sp (A3)	1 sp (A2)				(A4)	(A1)		2 x 6 hours with CP	CP
9	2 sp (A3)	2 sp (A2)						(A1)	2 x 2 hours with P1L	Pump 1
10	2 sp (A3)	2 sp (A2)					(A1)		2 x 6 hours with CP	CP
11	2 sp (A3)	2 sp (A2)				(A1)			2 x 2 hours with P1L	Pump 1
12	2 sp (A3)	2 sp (A2)				(A1)	(A0) <sup>2</sup>		2 purges, CP always on	CP
13	2 sp (A3)	1 sp (A2)	1 sp (A4)					(A1)	2 x 2 hours with P1L	Pump 1
14	2 sp (A3)	1 sp (A2)	1 sp (A4)				(A1)		2 x 6 hours with CP	CP
15	2 sp (A3)	1 sp (A2)	1 sp (A4)			(A1)			2 x 2 hours with P1L	Pump 1
16	2 sp (A3)	1 sp (A2)	1 sp (A4)			(A1)	(A0) <sup>2</sup>		2 purges, CP always on	CP
17	2 sp (A3)	2 sp (A2)	1 sp (A1)						2 x 2 hours with P1L	Pump 1
18	1 sp (A3)						(A1)	(A4)	2 x 6 hours with CP	CP
19	1 sp (A3)	1 sp (A2)					(A1)	(A4)	2 x 6 hours with CP	CP
20	1 sp (A3)	1 sp (A2)	1 sp (A4)				(A1)	(P43 tab) <sup>3</sup>	2 x 6 hours with CP	CP
21	1 sp (A3)	1 sp (A2)	1 sp (A4)	1 sp (A1)			(A0) <sup>2</sup>	(P43 tab) <sup>3</sup>	2 purges, CP always on	CP

#### Swim Spa

51	1 sp Master (A3)	1 sp Master (A2)	1 sp Slave (A3)	1 sp Slave (A2)		Slave (A4)	Master (A4)	Master (A1)	2 x 6 hours with CP	CP
52	2 sp Master (A3)	1 sp Master (A2)	1 sp Slave (A3)	1 sp Slave (A2)		Slave (A4)		Master (A1)	2 x 2 hours with P1L	Pump 1
53	1 sp Master (A3)	1 sp Master (A2)	1 sp Slave (A3)	1 sp Slave (A2)	1 sp Slave (A1)	Slave (A4)	Master (A4)	Master (A1)	2 x 6 hours with CP	CP
54	2 sp Master (A3)	1 sp Master (A2)	1 sp Slave (A3)	1 sp Slave (A2)	1 sp Slave (A1)	Slave (A4)		Master (A1)	2 x 2 hours with P1L	Pump 1

### Preloaded spa configurations, ID # 0610-221066-363, Software # 363 rev 5.0

Information between ( ) indicates which AMP connector to use. See above drawing for connector's position.

Config. #	Pump 1	Pump 2	Pump 3	Pump 4	Pump 5	Blower	DIRECT 1	DIRECT 2	Ozone <sup>5</sup>	Filter Cycle (Daily)	Heater Pump
1	2 sp (A3)						(A0)		(A1)	2 x 2 hours with P1L	Pump 1
2	2 sp (A3)	1 sp (A2)					(A0)		(A1)	2 x 2 hours with P1L	Pump 1
3	2 sp (A3)					(A4)	(A0)		(A1)	2 x 2 hours with P1L	Pump 1
4	2 sp (A3)	1 sp (A2)				(A4)	(A0)		(A1)	2 x 2 hours with P1L	Pump 1
5	2 sp (A3)	2 sp (A2)					(A0)		(A1)	2 x 2 hours with P1L	Pump 1
6	2 sp (A3)	2 sp (A2)				(A1)	(A0)		(A1)	2 x 2 hours with P1L	Pump 1
7	2 sp (A3)	1 sp (A2)	1 sp (A4)				(A0)		(A1)	2 x 2 hours with P1L	Pump 1
8	2 sp (A3)	1 sp (A2)	1 sp (A4)			(A1)	(A0)			2 x 2 hours with P1L	Pump 1
9	2 sp (A3)	2 sp (A2)	1 sp (A1)				(A0)			2 x 2 hours with P1L	Pump 1

#### Swim Spa

51	2 sp Master (A3)	1 sp Master (A2)	1 sp Slave (A3)	1 sp Slave (A2)		Slave (A4)	Master (A0)	Slave (A0)	Master (A1)	2 x 2 hours with P1L	Pump 1
52	2 sp Master (A3)	1 sp Master (A2)	1 sp Slave (A3)	1 sp Slave (A2)	1 sp Slave (A1)	Slave (A4)	Master (A0)	Slave (A0)	Master (A1)	2 x 2 hours with P1L	Pump 1

**Note 1:** When the Ozonator is not controlled by a relay, it can be tied to Pump 1 Low speed or Circ. Pump using cable AMP 9920-401369.

**Note 2:** Circ. pump is connected to a Direct fused outlet. Pump will always be on and may overheat if oversized pump is used.

**Note 3:** This accessory does not have its own AMP connector. Rewire A0 if not used or order extra AMP connector 9920-401346 (Black wire to P43 tab on the board, Green to any G tabs and white to any N tabs for 120 V accessory or any L2 tabs for 240 V).

**Note 4:** Configuration 7 is preselected from factory.

**Note 5:** When the Ozonator is not controlled by a relay, it can be tied to Pump 1 Low speed or Circ. Pump.

## Low Level Configuration

in.yj

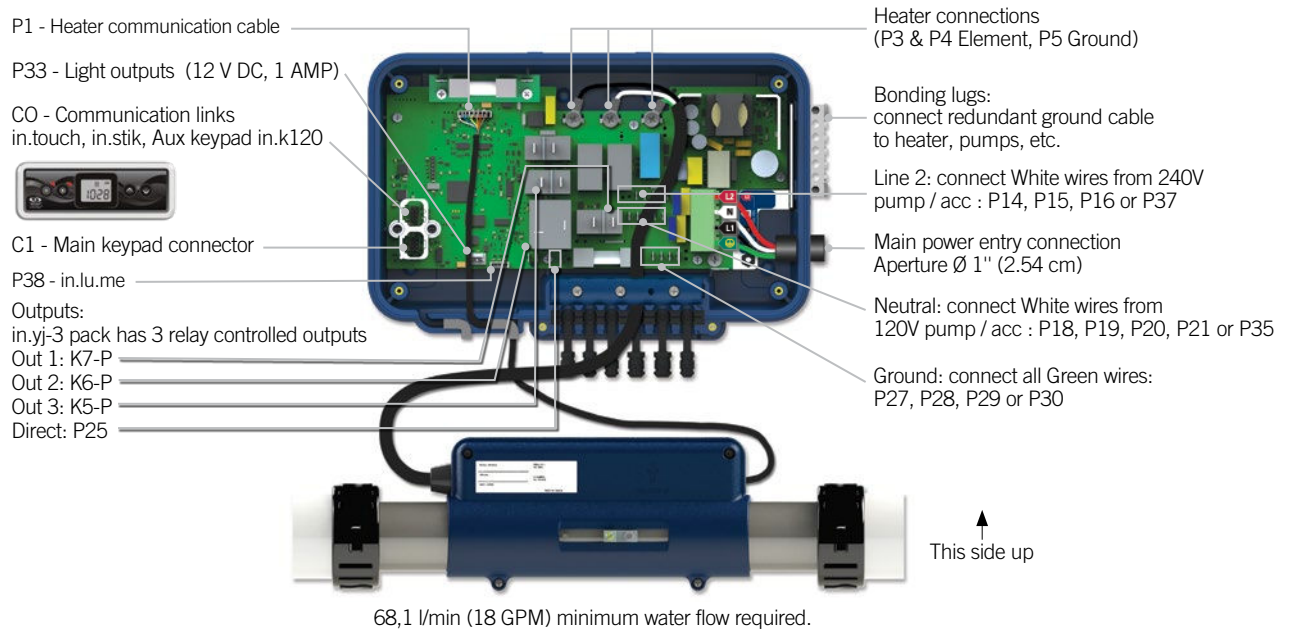

By default, this pack runs on Low level 1. Pump 1 dual speed, a 12 V light and a 4kW heater at 240 V.

### Preloaded spa configurations, in.yj-3 relays, ID # 0612-221041-431, Software # 431 rev 1.0

Information between ( ) indicates which connector/tab to use. See above drawing for connector's position.

Config. #	Pump 1	Pump 2	Blower	Circ. Pump (CP)	Ozone	Filter Cycle (Daily)	Heater Pump
1	2 sp (High: K7-P, Low: K6-P)				(K5-P)	2 x 1 hour with P1	Pump 1
2	1 sp (K7-P)				(K6-P)	2 x 1 hour with P1	Pump 1
3	1 sp (K7-P)	1sp (K6-P)			(K5-P)	2 x 1 hour with P1	Pump 1
4	1 sp (K7-P)			(K6-P)	(K5-P)	2 x 6 hours with CP	CP
5	2 sp (High: K7-P, Low: K6-P)			(K5-P)		2 x 6 hours with CP	CP
6	1 sp (K7-P)	1sp (K5-P)		(K6-P)		2 x 6 hours with CP	CP
7	1 sp (K7-P)			(K5-P)	(K6-P)	2 x 6 hours with CP	CP
8	2 sp (High: K7-P, Low: K6-P)	1sp (K5-P)				2 x 1 hour with P1	Pump 1
9	2 sp (High: K7-P, Low: K6-P)		(K5-P)			2 x 1 hour with P1	Pump 1
10	2 sp (High: K7-P, Low: K6-P)	1sp (K5-P)		(P25) <sup>1</sup>		2 x day purge	CP
11	2 sp (High: K7-P, Low: K6-P)		(K5-P)	(P25) <sup>1</sup>		2 x day purge	CP

**Note 1:** Circulation pump is not controlled via a relay and will run 24/7. Circulation pumps must provide at least 68,1 L/min (18 GPM) without creating kinetic heating of the water (Gecko recommends using the Aqua-Flo Circ-Master - 1/15 HP).

## Low Level Configuration

in.xe

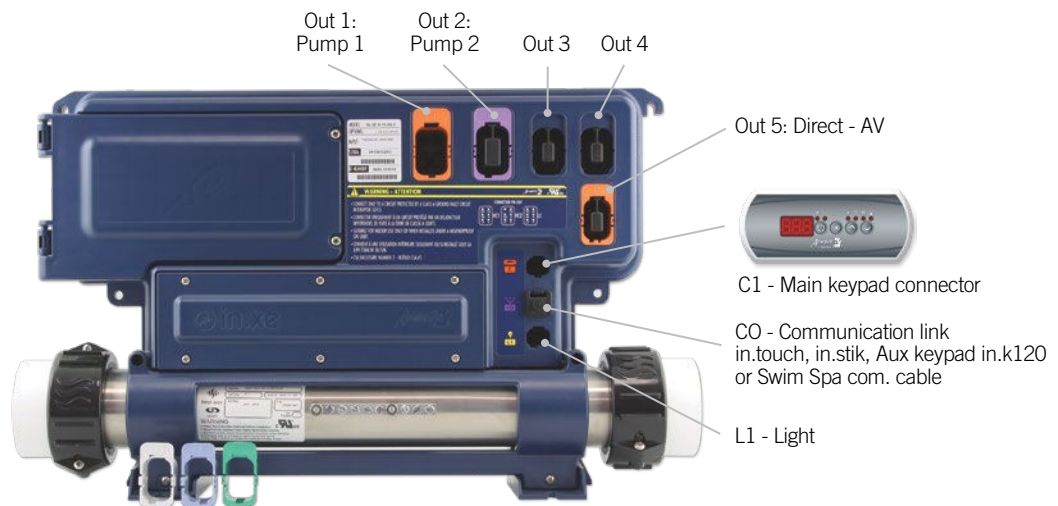

Don't forget the voltage is determined by the cable used (120 or 240V cable)!

### Preloaded spa configurations, ID # 0602-221063-299, Software # 299 rev 3.0

Information between ( ) indicates which in.link port to use. See above drawing for port's position.

Config.#	Pump 1	Pump 2	Pump 3	Pump 4	Pump 5	Blower	Circ.Pump (CP)	Ozone <sup>1</sup>	Filter Cycle (Daily)	Heater Pump
1	2 sp (Out 1)							(Out 4)	2 x 2 hours with P1	P1
2	2 sp (Out 1)						(Out 3)	(Out 4)	2 x 6 hours with CP	CP
3	2 sp (Out 1)	1 sp (Out 2)						(Out 4)	2 x 2 hours with P1	P1
4	2 sp (Out 1)	1 sp (Out 2)					(Out 3)	(Out 4)	2 x 6 hours with CP	CP
5	2 sp (Out 1)					(Out 3)		(Out 4)	2 x 2 hours with P1	P1
6	2 sp (Out 1)					(Out 3)	(Out 4)		2 x 6 hours with CP	CP
7	2 sp (Out 1)	1 sp (Out 2)				(Out 3)		(Out 4)	2 x 2 hours with P1	P1
8	2 sp (Out 1)	1 sp (Out 2)				(Out 3)	(Out 4)		2 x 6 hours with CP	CP
9	1 sp (Out 1)						(Out 3)	(Out 4)	2 x 6 hours with CP	CP
10	1 sp (Out 1)	1 sp (Out 2)					(Out 3)	(Out 4)	2 x 6 hours with CP	CP
11	1 sp (Out 1)	1 sp (Out 2)				(Out 3)	(Out 4)		2 x 6 hours with CP	CP
12	1 sp (Out 1)	1 sp (Out 2)						(Out 4)	2 x 2 hours with P1	P1
13	1 sp (Out 1)	1 sp (Out 2)				(Out 3)		(Out 4)	2 x 2 hours with P1	P1
14	2 sp (Out 1)	1 sp (Out 2)				(Out 3)	(Out 4)		2 x 6 hours with CP	P1

#### Swim Spa

51	2 sp (Master Out 1)	1 sp (Master Out 2)	1 sp (Slave Out 1)	1 sp (Slave Out 2)			(Master Out 3)	(Master Out 4)	2 x 6 hours with CP	CP
52	2 sp (Master Out 1)	1 sp (Master Out 2)	1 sp (Slave Out 1)	1 sp (Slave Out 2)				(Master Out 4)	2 x 2 hours with P1	P1
53	2 sp (Master Out 1)	1 sp (Master Out 2)	1 sp (Slave Out 1)	1 sp (Slave Out 2)		1 sp (Slave Out 3)	(Master Out 3)	(Master Out 4)	2 x 6 hours with CP	CP
54	2 sp (Master Out 1)	1 sp (Master Out 2)	1 sp (Slave Out 1)	1 sp (Slave Out 2)		1 sp (Slave Out 3)		(Master Out 4)	2 x 2 hours with P1	P1
55	2 sp (Master Out 1)	1 sp (Master Out 2)	1 sp (Slave Out 1)				(Master Out 3)	(Master Out 4)	2 x 6 hours with CP	CP
56	2 sp (Master Out 1)	1 sp (Master Out 2)	1 sp (Slave Out 1)					(Master Out 4)	2 x 2 hours with P1	P1
57	2 sp (Master Out 1)	1 sp (Master Out 2)	1 sp (Slave Out 1)			1 sp (Slave Out 3)	(Master Out 3)	(Master Out 4)	2 x 6 hours with CP	CP
58	2 sp (Master Out 1)	1 sp (Master Out 2)	1 sp (Slave Out 1)			1 sp (Slave Out 3)		(Master Out 4)	2 x 2 hours with P1	P1
59 <sup>2</sup>	2 sp (Master Out 2)	1 sp (Master Out 1)	1 sp (Slave Out 1)	1 sp (Slave Out 1)	1 sp (Slave Out 2)		(Master Out 3)	(Master Out 4)	2 x 6 hours with CP	CP

### Preloaded spa configurations, ID # 0602-221066-300, Software # 300 rev 3.0

Information between ( ) indicates which in.link port to use. See above drawing for port's position.

Config. #	Pump 1	Pump 2	Blower	Circ. Pump (CP)	Ozone <sup>1</sup>	Filter Cycle (Daily)	Heater Pump
1	2 sp (Out 1)				(Out 4)	2 x 2 hours with P1	Pump 1
2	2 sp (Out 1)			(Out 4)		2 x 6 hours with CP	Circulation Pump
3	2 sp (Out 1)		(Out 4)			2 x 2 hours with P1	Pump 1
4	2 sp (Out 1)	1 sp (Out 2)			(Out 4)	2 x 2 hours with P1	Pump 1
5	2 sp (Out 1)	1 sp (Out 2)		(Out 4)		2 x 6 hours with CP	Circulation Pump
6	2 sp (Out 1)	1 sp (Out 2)	(Out 4)			2 x 2 hours with P1	Pump 1
7	2 sp (Out 1)	2 sp (Out 2)			(Out 4)	2 x 2 hours with P1	Pump 1
8	2 sp (Out 1)	2 sp (Out 2)		(Out 4)		2 x 6 hours with CP	Circulation Pump
9	2 sp (Out 1)	2 sp (Out 2)	(Out 4)			2 x 2 hours with P1	Pump 1

**Note 1:** When the Ozonator is not controlled by a relay, it can be tied to Pump 1 Low speed or Circ. Pump.

**Note 2:** Slave (OUT 1) high and low speed dedicated to Pump 3 and pump 4 respectively.



**Canada**

450 des Canetons, Quebec City QC  
G2E 5W6 Canada  
Tel: 1.800.784.3256  
[techsupport@geckoal.com](mailto:techsupport@geckoal.com)

**Europe**

Europe: +33 80 50 80 352  
UK: +44 (0)800 060 8300  
[techsupport@geckoal.com](mailto:techsupport@geckoal.com)

Official Gecko Alliance distributors for  
Gecko products and Aqua-Flo pumps

Canada



[www.aquaspaandpoolsupply.com](http://www.aquaspaandpoolsupply.com)



**Central**  
*Spa & Pool Supply*

[www.centralspasupply.com](http://www.centralspasupply.com)

USA



[www.actionspaparts.com](http://www.actionspaparts.com)



**Baystate Pool Supplies**

[www.baystatepools.com](http://www.baystatepools.com)



[www.baystatepools.com](http://www.baystatepools.com)



[www.horizonparts.com](http://www.horizonparts.com)



**Cinderella Inc.**  
*We're Making Waves.*

[www.cinderellainc.com](http://www.cinderellainc.com)



[www.spaparts.com](http://www.spaparts.com)



[www.scppool.com](http://www.scppool.com)



SCP Distributors LLC

[www.scppool.com](http://www.scppool.com)



[www.kellersupply.com](http://www.kellersupply.com)

