

maelstrom™

VMS-1

Quick Start Guide

VMS-1

The quietest massage pump in the spa industry



Compact

Energy-efficient

Massage experience





Warnings



WARNINGS: Before installing or connecting the unit, please read the following:

- * IF THE SUPPLY CORD IS DAMAGED, IT MUST BE REPLACED BY THE MANUFACTURER, ITS SERVICE AGENT OR SIMILARLY QUALIFIED PERSONS IN ORDER TO AVOID A HAZARD.
- * AFTER VMS-1 IS DE-ENERGIZED (TURNED POWER OFF), THERE WILL BE A RESIDUAL CHARGE IN THE UNIT. WAIT AT LEAST TWO MINUTES BEFORE SERVICING OR MODIFYING ANY CABLE CONNECTIONS IN THIS UNIT TO ALLOW SUFFICIENT TIME FOR THE CAPACITOR TO DISSIPATE STORED ENERGY.
- * THIS PUMP MUST NOT BE INSTALLED IN PROXIMITY TO HIGHLY FLAMMABLE MATERIALS.
- * THIS PUMP MUST BE SUPPLIED THROUGH A RESIDUAL CURRENT DEVICE (RCD) HAVING A RATED RESIDUAL OPERATING CURRENT NOT EXCEEDING 30 MA.
- * LOW SUPPLY VOLTAGE OR IMPROPER WIRING MAY CAUSE DAMAGE TO THIS PUMP. READ AND FOLLOW ALL WIRING INSTRUCTIONS WHEN CONNECTING TO POWER SUPPLY.
- * THIS PUMP CONTAINS NO USER SERVICEABLE PARTS. CONTACT AN AUTHORIZED SERVICE CENTER FOR SERVICE.
- * PRODUCT MUST BE DISPOSED OF SEPARATELY IN ACCORDANCE WITH LOCAL WASTE DISPOSAL LEGISLATION.
- * THIS APPLIANCE IS NOT INTENDED FOR USE BY PERSONS (INCLUDING CHILDREN) WITH REDUCED PHYSICAL, SENSORY OR MENTAL CAPABILITIES, OR LACK OF EXPERIENCE AND KNOWLEDGE, UNLESS THEY HAVE BEEN GIVEN SUPERVISION OR INSTRUCTION CONCERNING USE OF THE APPLIANCE BY A PERSON RESPONSIBLE FOR THEIR SAFETY.
- * CHILDREN SHOULD BE SUPERVISED TO ENSURE THAT THEY DO NOT PLAY WITH THE APPLIANCE.
- * PARTS INCORPORATING ELECTRICAL COMPONENTS, EXCEPT REMOTE CONTROL DEVICES, MUST BE LOCATED OR FIXED SO THAT THEY CANNOT FALL INTO THE BATH OR hot tub.
- * CLEARANCE AND MINIMUM DISTANCE BETWEEN THE VARIOUS PARTS OF THE APPLIANCE AND THE SURROUNDING STRUCTURE ARE NOT SPECIFIED AS LONG AS THEY ARE SUFFICIENT SO THAT THE AMBIENT TEMPERATURE AROUND THE PUMP DOES NOT EXCEED 60°C.
- * PARTS ARE TO BE INSTALLED IN THE CORRECT ZONE AND EQUIPOTENTIAL BONDING CARRIED OUT IN ACCORDANCE WITH WIRING RULES.

Step 1 - Installation

Important! Read before starting:

Please note that countersunk screws should not be used as they can damage the pump stand.



Warning! Beware of the application of some products commonly used against corrosion (such as the WD-40 family of products) as they could damage the pump, due to a negative chemical reaction between some industrial oils and its plastic enclosure. Any other materials that may come into contact with the enclosure must be carefully evaluated under end-use conditions for compatibility.

The VMS-1 pump can be installed in two different orientations: with the water output on top of the pump pushing water vertically or with the water output on the side of the pump pushing water horizontally. See pictures below.

R0/R9 wet-end orientation

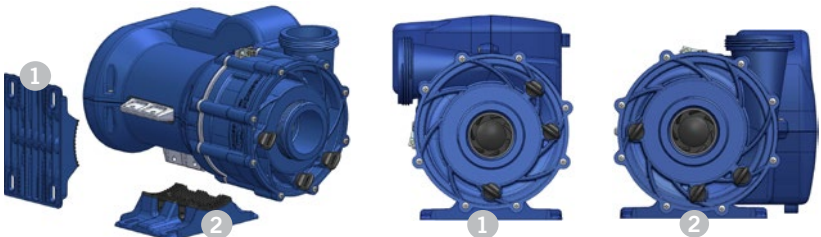

Step 1 - Installation

R0/R3 wet-end orientation

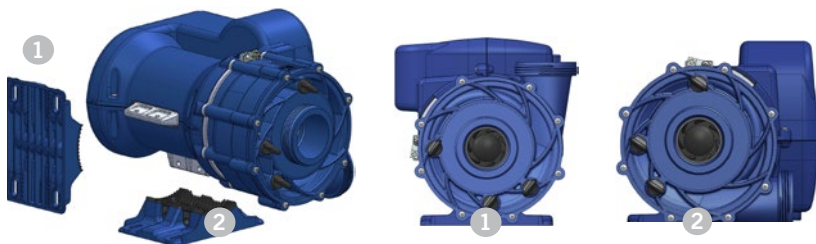

To change the pump orientation, you must remove the two Phillips screws holding the fixation stand to the pump.

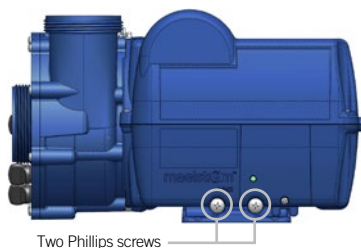

Select the most appropriate location on the floor for the VMS-1 and firmly attach the stand to the wooden base using four screws size 1/4 in (M7) or 5/16 in (M8) backed by four washers. Torque screws to 18 lbf. in max (2.03 N.m)



Warning! Do not overtighten the two Phillips screws when reinstalling the pump on the fixation stand. Torque above 8 lbf.in is considered excessive and might damage the rubber, and overtightening the rubber mount will increase the vibration transmission.



Step 2 - Connections

Connecting the pump to the hot tub control system



Turn off power before connecting the VMS-1 to the hot tub control system.

Note: Contact your sales representative for EMI-friendly wiring installation recommendations.

Communication cable connection to the hot tub control system

Once the pump is installed in the desired orientation, open the hot tub control system and connect the communication cable from the pump to the six-pin connector labeled A.FLX (see below).

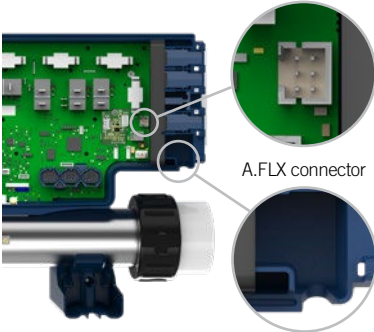

A.FLX connector

Strain-relief channel

in.ye-V3 control system

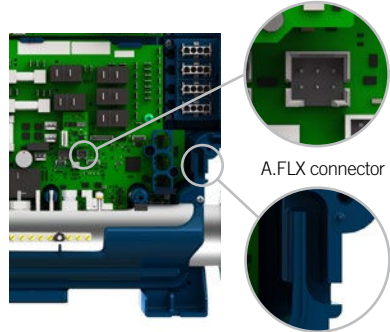

A.FLX connector

Strain-relief channel

in.yt-V2FLX control system

Pump power cable connection to the hot tub control system

Then connect the pump power cable to the hot tub control system. Make sure you use the output specified in your hot tub control system's low-level configuration. Close the hot tub control system enclosure and turn the power on.

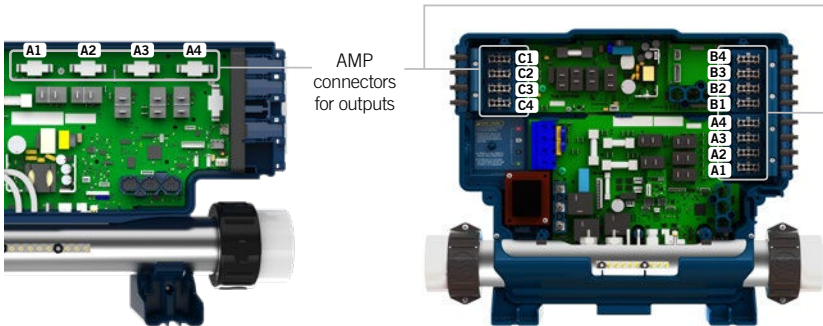

AMP connectors for outputs

in.ye-V3 control system

in.yt-V2FLX control system



Step 2 - Connections

Communication cable connection to the pump: with single pump

The communication cable going to the hot tub control system should have been connected to the 4-pin communication connector (factory setting).

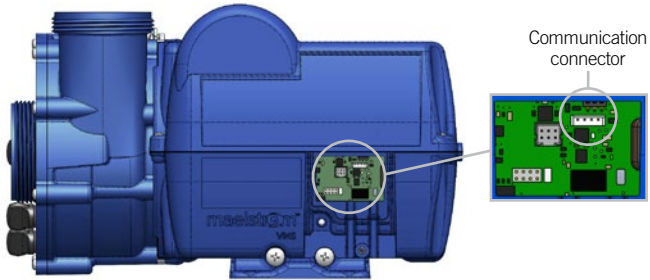

Communication cable connection to the pump: with multiple pumps

Multiple pumps can be daisy-chained via communication cables. Connect the first pump as instructed above. For every additional pump, a communication cable should have been connected to the 4-pin communication connector (factory setting). Connect this communication cable to the 6-pin A.FLX connector of the previous pump.

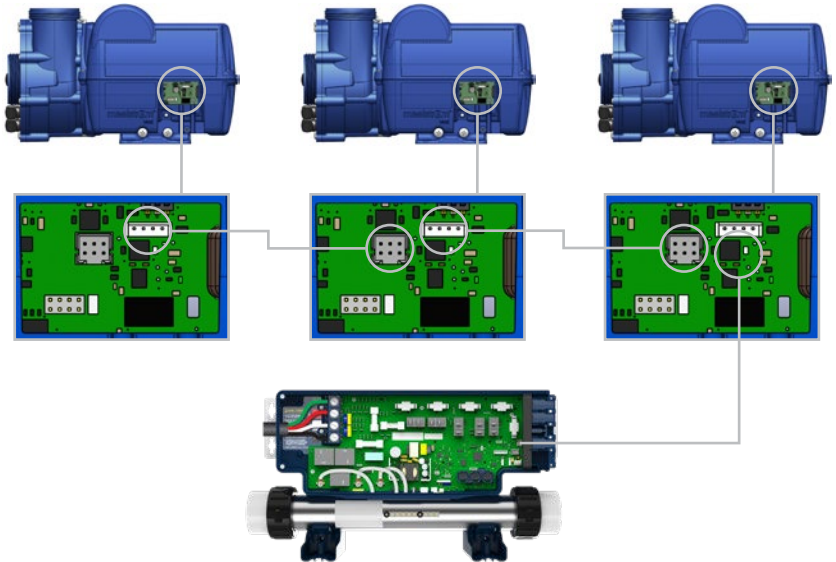

Step 2 - Connections

Configuring pump address using DIP switches

Each pump requires a software address to be configured to match the hot tub control system configuration. This address is configured via a DIP switch module mounted on the board.

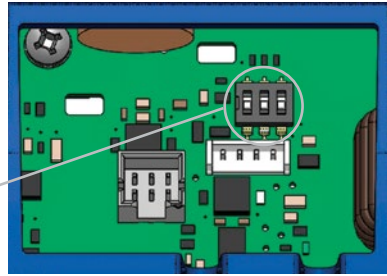
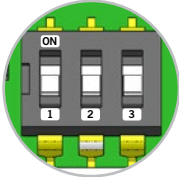

The module has three switches, labeled 1, 2 and 3 on the module. Each switch can be either in the “on” or “off” position. Each VMS address is encoded in binary format from those positions. Refer to the following table to set the switches to the correct position for a given address. If your setup consists of a single VMS pump, the DIP switches should be set to the “VMS 1” configuration in the table.

Configuration	Switch 1	Switch 2	Switch 3
VMS 1	ON	OFF	OFF
VMS 2	OFF	ON	OFF
VMS 3	ON	ON	OFF
VMS 4	OFF	OFF	ON
VMS 5	ON	OFF	ON

Step 3

On an in.k1000, if the pump is detected a special variable speed pump icon will show up. To start the pump click on the icon, a small slider will pop-up to allow speed adjustment of the pump.

Variable speed pump icon on



Variable speed pump icon off



Variable speed slider



GECKO®
Gecko Alliance

450 des Canetons, Québec (Qc), G2E 5W6 Canada
1.800.78.GECKO
www.geckoalliance.com

9919-101743-B
Rev. 04-2024

© Groupe Gecko Alliance inc., 2024
All trademarks or registered trademarks
are the property of their respective owners.