

in.tune panel housing



30° mounting bezel for in.tune
am/fm receiver / mp3 / cd player

installation instructions

Designed to facilitate the installation
of in.tune onto a spa panel.





Introduction

The in.tune panel housing is a 30° embedded fitting designed to facilitate the installation of the in.tune player onto a spa panel. When properly installed, this UL approved bezel system helps to protect the in.tune player specially through packaging and transportation of the spa. Made of durable and lightweight plastic, the in.tune panel housing adds mounting flexibility, ease of use and better view angle.



WARNING

Before installing or connecting the unit, please read the following.

DO NOT BLOCK VENTS OR RADIATOR PANELS.

Doing so may cause heat to build up inside and may result in fire.

DO NOT USE FOAM TO ISOLATE THE UNIT.

Doing so may cause heat to build up inside and may result in fire.

INSTALL UNIT 1" AWAY FROM OTHER SURFACES.

Make sure to leave a clearance of at least 1" from other surfaces.

FAILURE TO APPLY SILICONE MAY DAMAGE THE UNIT AND SURROUNDING EQUIPMENT.

THE IN.TUNE MUST ALWAYS BE INSTALLED WITH THE MOUNTING STRAP FIRMLY FIXED TO A SOLID PART.

Failure to do so may result in damage to the unit and annulment of the warranty.



PRECAUTIONS

Accessory parts

Be sure to use only the specified accessory parts. Use of other than designated parts may damage the in.tune player internally or may not securely install the unit in place. This may cause parts to become loose resulting in hazards or product failure.

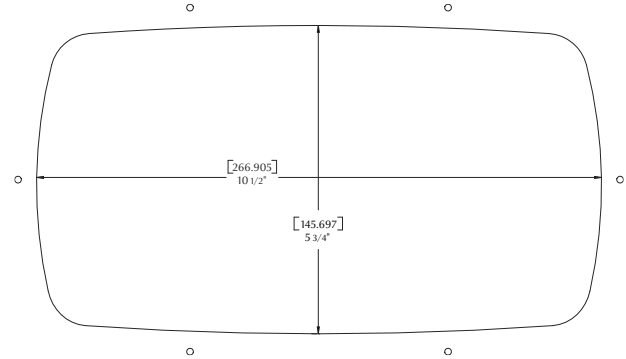
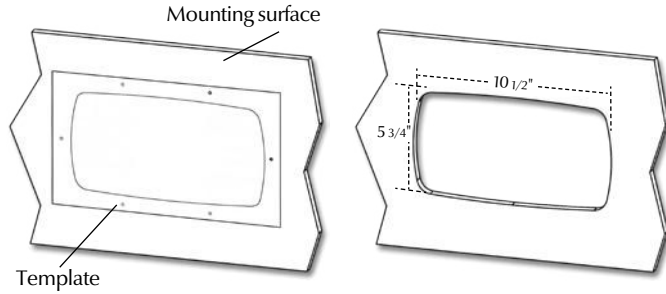

Step 1

Using the drilling template supplied with the unit, determine the mounting location and then stick the template on the location.

Once the desired location is established, place guide template and with a hole saw, drill a starter hole at the outline of the template. With a jigsaw, cut all around the edges of the template.

Then drill six 1/8" (3 mm) mounting holes in the exact position according to the drilling template.

Safety: Protective eyewear should be worn by anyone operating equipment used in the installation of the in.tune mounting bezel.

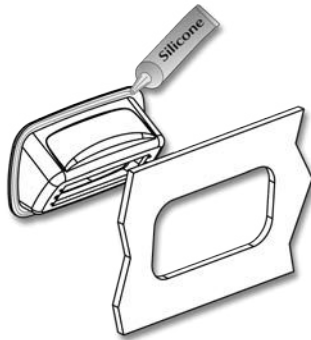

Step 2

Make a silicone joint between the installation location and the enclosure (to avoid water leakage). Apply silicone all around the enclosure. Let the silicone dry and remove excess.

Note: Failure to apply silicone may damage the unit and surrounding equipment!

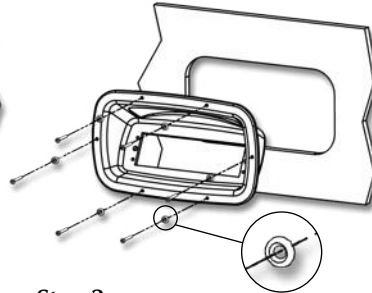

Step 3

Use 6 oval head stainless steel screws #10 x 1 1/4" as well as 6 stainless steel finishing washers #10 to fix the enclosure.

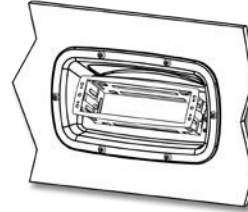

Step 4

Insert the mounting sleeve into the hole (installation opening).

Note: See in.tune user manual for complete installation instructions.

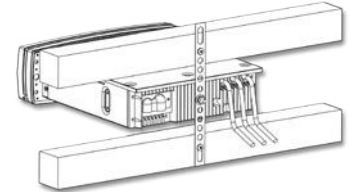

Important:

The in.tune must always be installed with the mounting strap firmly fixed to a solid part. Failure to do so may result in damage to the unit and annulment of the warranty.

Note: See in.tune manual for more details.

in U.S.A. available through



Spa Builders Systems Group
9225 Stellar Court, Corona
CA, USA 92883, 1.866.639.7274

9919-100608-C



www.aeware.ca

in Canada, available through



Gecko Electronics Inc.
450 des Canetons, Quebec City (Quebec)
G2E 5W6 Canada, 1.800.78.GECKO

